

# CITY OF KELOWNA

## BYLAW NO. 11438 - TA17-0002 – CD2 – Kettle Valley Comprehensive Development

---

A bylaw to amend the "City of Kelowna Zoning Bylaw No. 8000".

The Municipal Council of the City of Kelowna, in open meeting assembled, enacts as follows:

1. THAT **Schedule B – CD 2 – Kettle Valley Comprehensive Development Zone** be amended by:
  - a) Deleting the "Kettle Valley Proposed Regulating Plan" map in its entirety as attached to and forming part of this bylaw as Map A;
  - b) Deleting the "Kettle Valley Regulating Plan" map as attached to and forming part of this bylaw as Map B and replacing it with a new "Kettle Valley Regulating Plan" Map as attached to and forming part of this bylaw as Map C;
  - c) Deleting the "CD2 – Kettle Valley Comprehensive Residential Development – Map 1 Page 4 of 17" map in its entirety as attached to and forming part of this bylaw as Map D;
  - d) Deleting the "CD2 – Kettle Valley Comprehensive Residential Development – Map 1 Page 5 of 17" map as attached to and forming part of this bylaw as Map E and replacing it with a new "CD2 – Kettle Valley Comprehensive Residential Development – Map 1 Page 5 of 17" as attached and forming part of this bylaw as Map F;
2. This bylaw shall come into full force and effect and is binding on all persons as and from the date of adoption.

Read a first time by the Municipal Council this 26<sup>th</sup> day of June, 2017.

Considered at a Public Hearing on the

Read a second and third time by the Municipal Council this

Adopted by the Municipal Council of the City of Kelowna this

\_\_\_\_\_  
Mayor

\_\_\_\_\_  
City Clerk

Map A

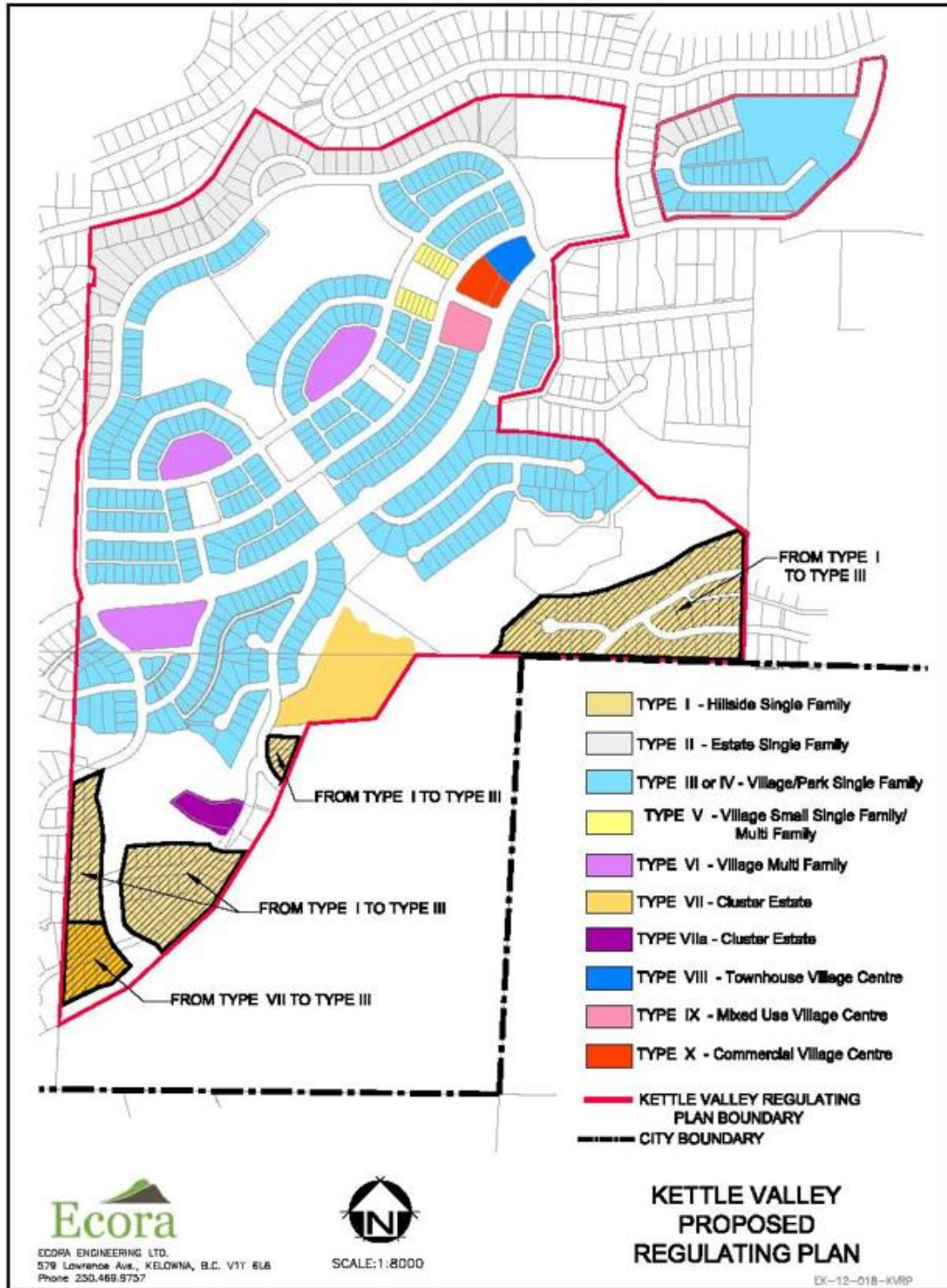

Map B

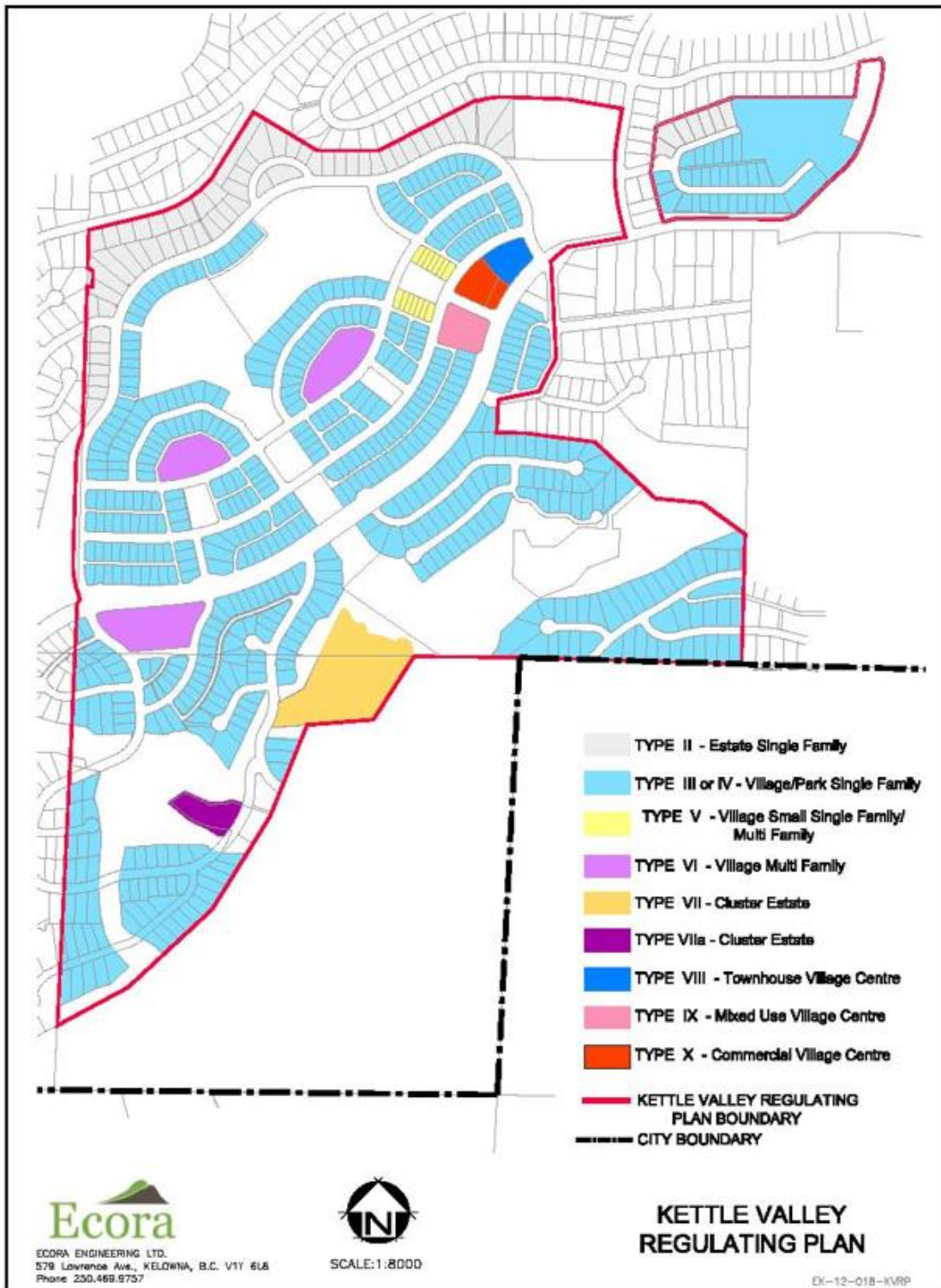

Map C

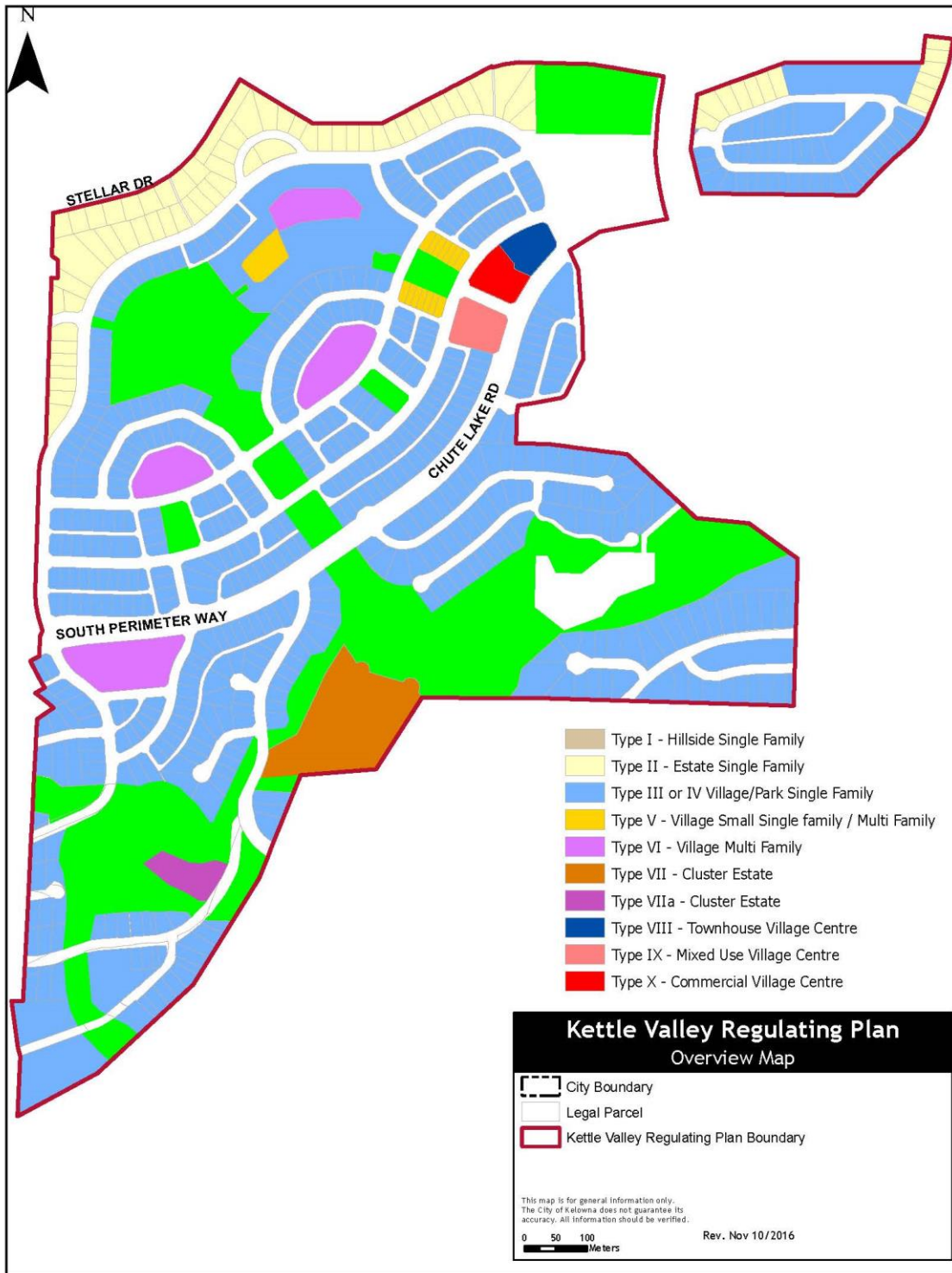

Map D

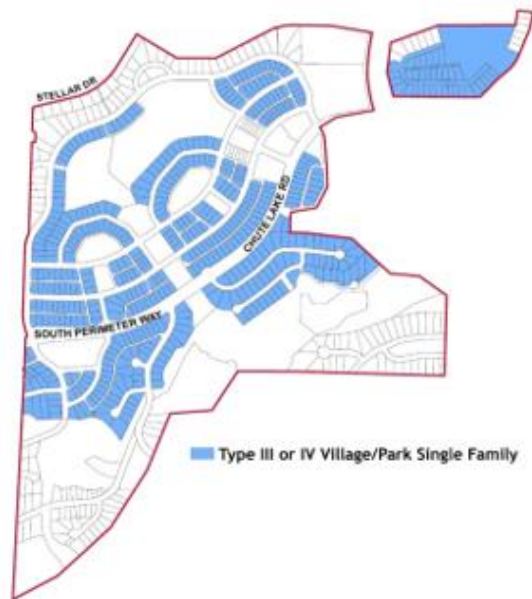
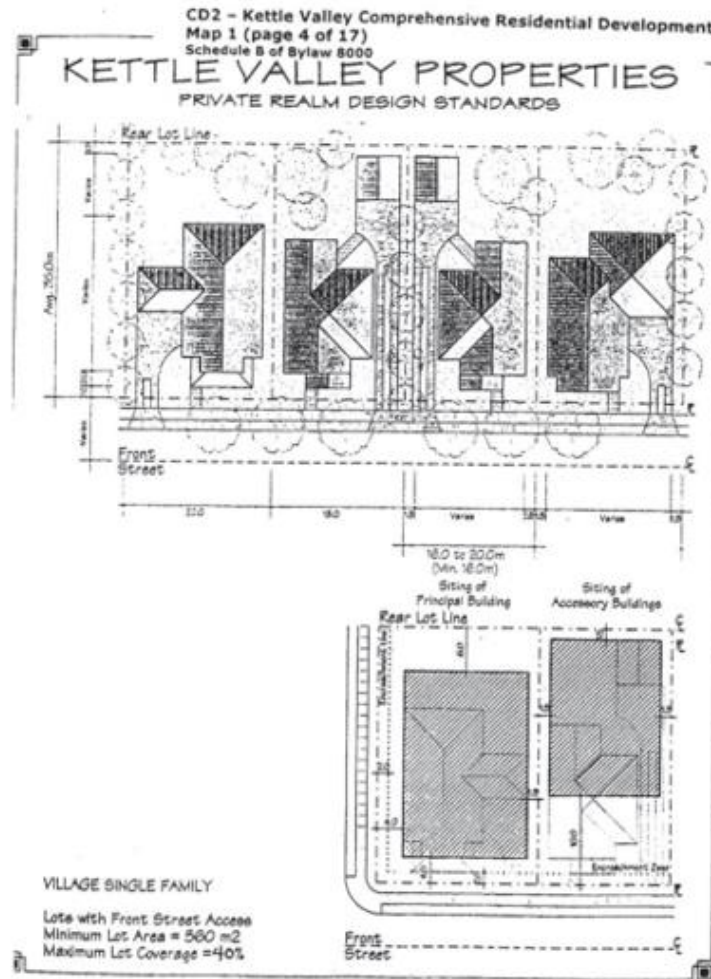

Map E

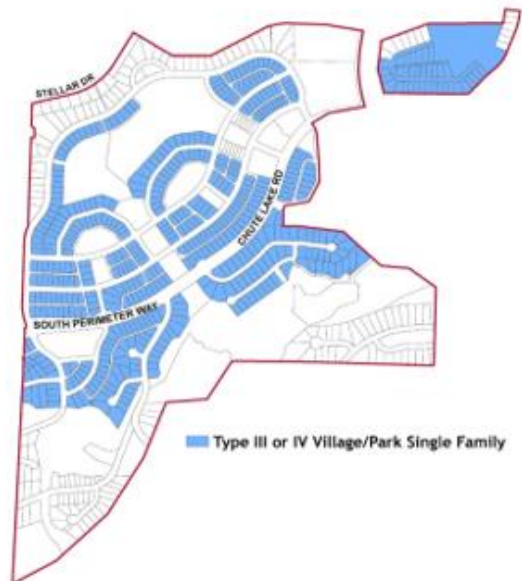
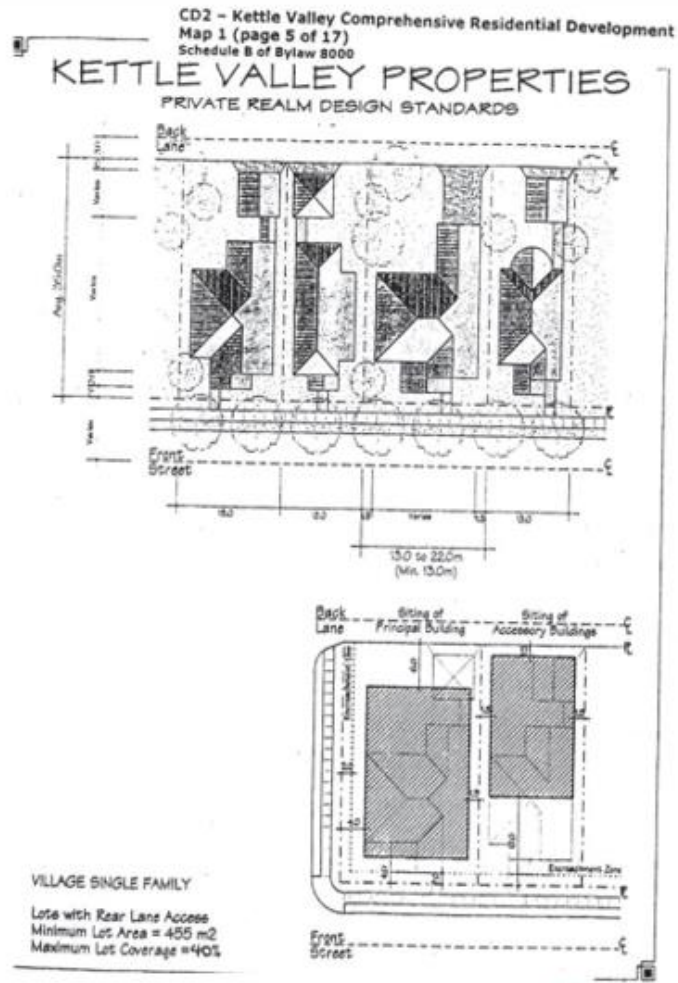

Map F

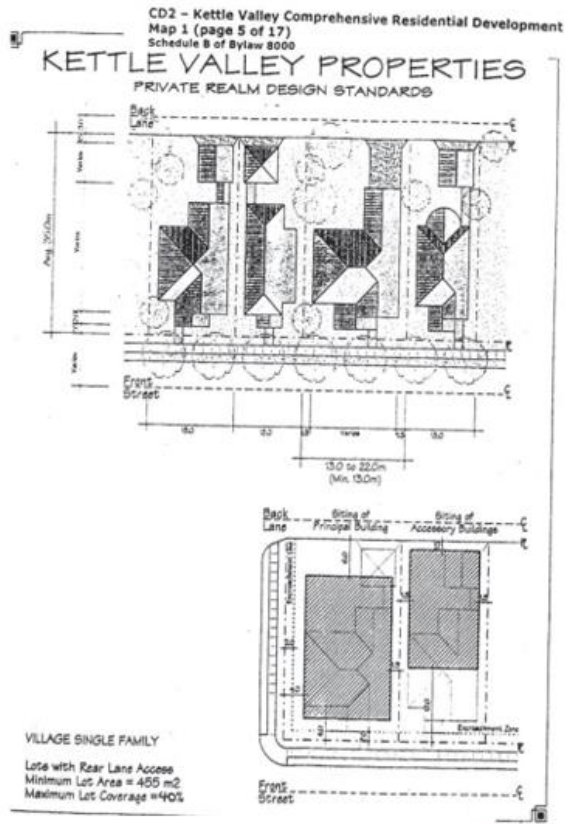

■ Type III or IV Village/Park Single F

