



**Subject Properties Notes
1700 Tower Ranch Blvd**

Amend the OCP for portions of the Subject Property from Private Recreation (REC) and Park to Single/Two Unit Residential - Hillside (S2RESH)

**Subject Property Notes
1700 Tower Ranch Blvd**

Amend the OCP for a portion of the subject property from Private Recreation (REC) to Major Park and Open Space (PARK).

**Subject Properties Notes
1638 Tower Ranch Blvd**

Amend the OCP for portions of the Subject Property from Single/Two Unit Residential - Hillside (S2RESH) to Private Recreation (REC).

**Subject Properties Notes
1700 Tower Ranch Blvd**

Amend the OCP for portions of the Subject Property from Private Recreation (REC) to Single/Two Unit Residential (S2RES)

**Subject Properties Notes
1700 Tower Ranch Blvd**

Amend the OCP for portions of the Subject Property from Single/Two Unit Residential (S2RES) to Major Park and Open Space (PARK).

**Subject Properties Notes
1700 Tower Ranch Blvd**

Amend the OCP for portions of the Subject Property from Single/Two Unit Residential - Hillside (S2RESH) to Major Park and Open Space (PARK).

**Subject Property Notes
1700 Tower Ranch Blvd**





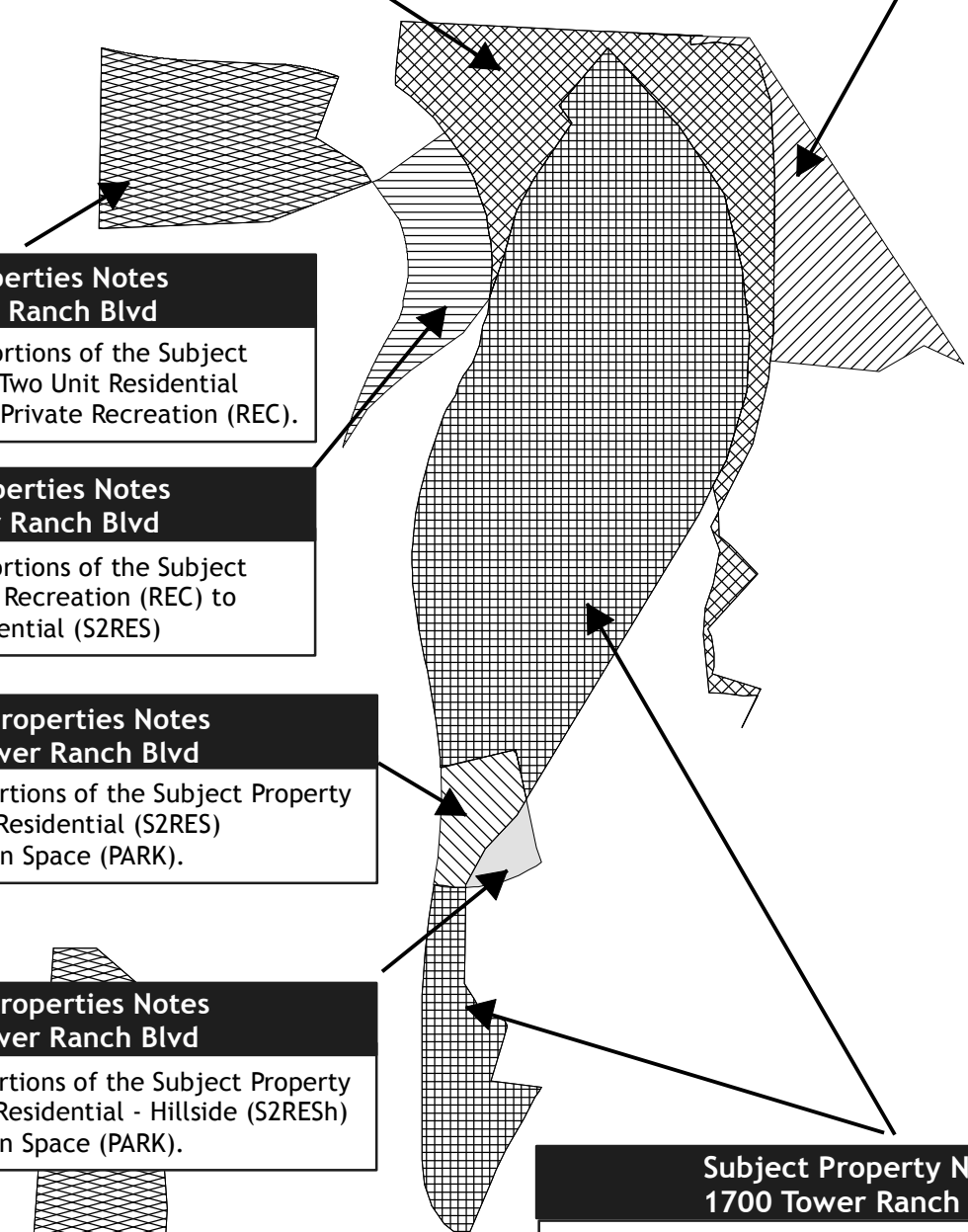

Amend the OCP for a portion of the Subject Properties from Single/Two Unit Residential (S2RES) to Single/Two Unit Residential Hillside (S2RESH).

**Subject Properties Notes
1638 Tower Ranch Blvd**

Amend the OCP for portions of the Subject Property from Single/Two Unit Residential - Hillside (S2RESH) to Private Recreation (REC).



**MAP "A" OCP AMENDMENT
OCP16-0005**

-  REC to PARK
-  REC to S2RES
-  REC to S2RESH
-  S2RES to PARK
-  S2RES to S2RESH
-  S2RESH to PARK
-  S2RESH to REC

This map is for general information only. The City of Kelowna does not guarantee its accuracy. All information should be verified.

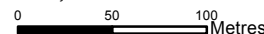

City of
Kelowna



Subject Property Notes:

Rezone a portion of the subject property from P3 Parks and Open Space to RU6 - Two Dwelling Housing.

Subject Property Notes:

Rezone a portion of the subject property from P3 Parks and Open Space to RU2H - Medium Lot Residential (Hillside).

Subject Property Notes:

Rezone a portion of the subject property from RU6 - Two Dwelling Housing to RU2H - Medium Lot Residential (Hillside).

Subject Property Notes:

Rezone a portion of the subject property from RU6 - Two Dwelling Housing to P3 - Parks and Open Space.

Subject Property Notes:

Rezone a portion of the subject property from RU1h - Large Lot Housing - Hillside to RU2H - Medium Lot Residential - Hillside.

Subject Property Notes:

Rezone a portion of the subject property from RU1H - Large Lot Housing (Hillside Area) to P3 - Parks and Open Space.

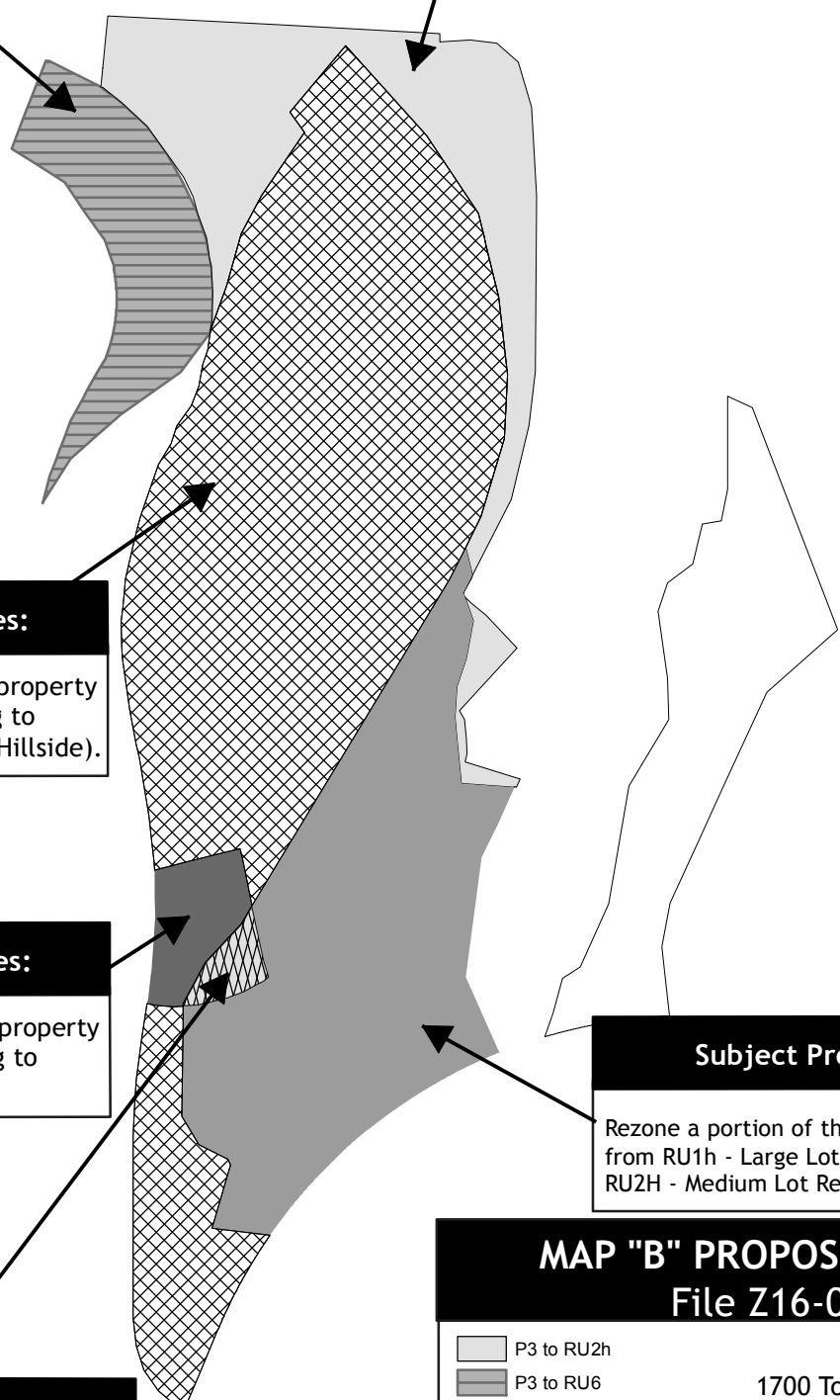

**MAP "B" PROPOSED ZONING
File Z16-0078**

- P3 to RU2h
- P3 to RU6
- RU1h to P3
- RU1h to RU2h
- RU6 to P3
- P3
- RU6 to RU2h

1700 Tower Ranch Blvd

This map is for general information only. The City of Kelowna does not guarantee its accuracy. All information should be verified.

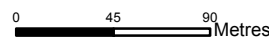

Rev. Wednesday, May 17, 2017



FUTURE LAND USE:
 MAJOR PARK
 SINGLE 2 UNIT RESIDENTIAL
 PRIVATE RECREATION
 SINGLE 2 UNIT RESIDENTIAL HILLSIDE
 BORDER

1
 80933

LEGAL DESCRIPTION:
 PROPOSED SUBDIVISION OF LOT 2, PLAN 80933,
 O.D.Y.D

PHASE 7 AREA: 30514m² (3.05 HECTARES)

PRIVATE RECREATION

MAJOR PARK

SINGLE 2 UNIT
 RESIDENTIAL HILLSIDE

LOCATION PLAN
 SCALE 1:20000

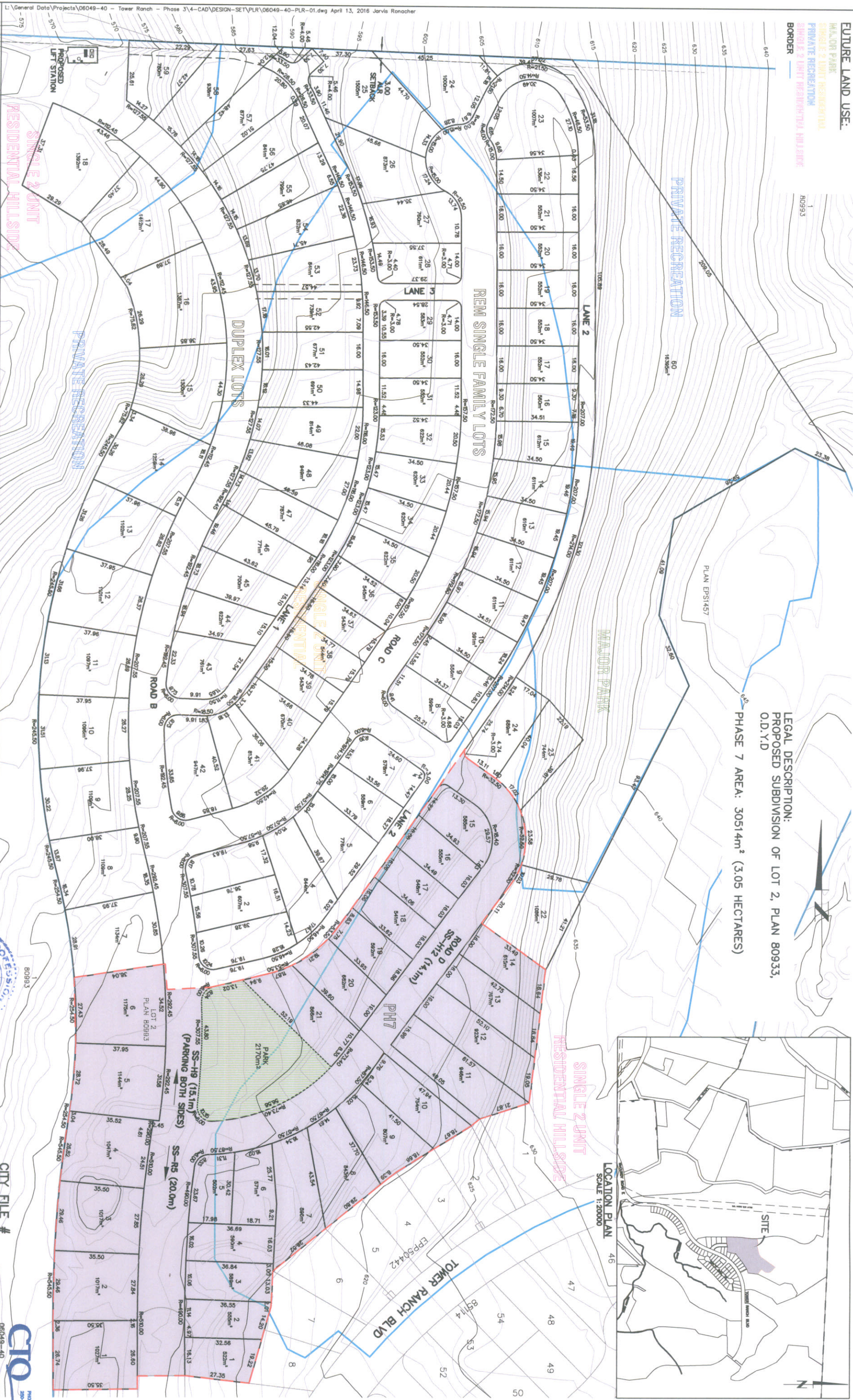

No.	1	16.01.14	DC	PRELIMINARY LAYOUT REVIEW	Issued	
By						
No.	2	16.04.13	JR	ADJUSTED ROAD WIDTHS		
By						
No.	1	16.03.30	LT	ADJUSTED TO FUTURE LAND USE LINES	Revision	
By						
Child No.						
Child						

Drawn	JR
Checked	JR
Approved	JR
Date	JANUARY 2016
Scale	1:1500

THE CITY OF KELOWNA
 ENGINEERING DEPARTMENT
 TOWER RANCH DEVELOPMENT
 DILWORTH BLOCK PHASE 7
 PRELIMINARY LAYOUT REVIEW

CIO
 PHONE: 250-779-1231
 250-779-1231

Division	MUNICIPAL
Drawing No.	PLR-01
Rev No.	2

PRELIMINARY LAYOUT REVIEW