

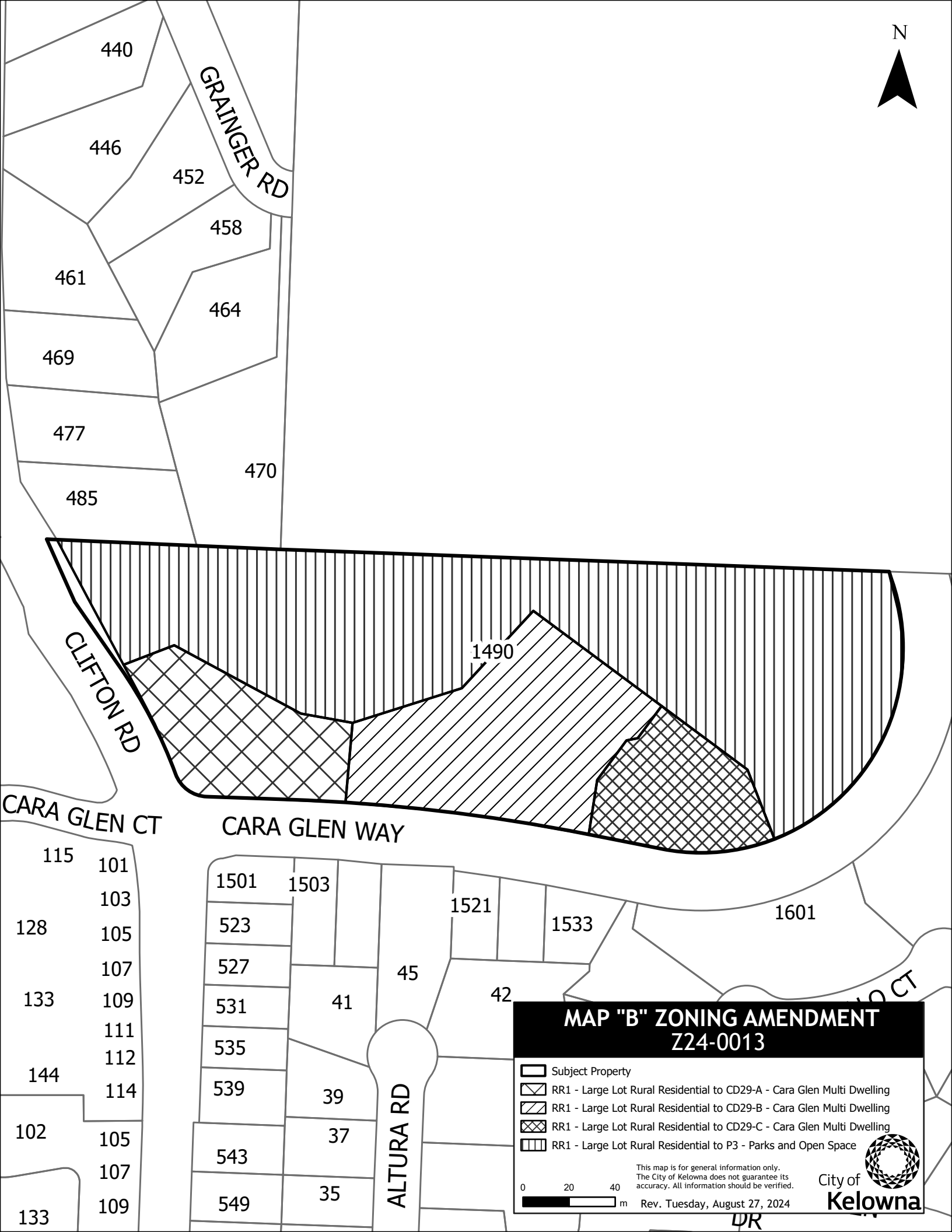





N



MAP "B" ZONING AMENDMENT Z24-0013

-  Subject Property
-  RR1 - Large Lot Rural Residential to CD29-A - Cara Glen Multi Dwelling
-  RR1 - Large Lot Rural Residential to CD29-B - Cara Glen Multi Dwelling
-  RR1 - Large Lot Rural Residential to CD29-C - Cara Glen Multi Dwelling
-  RR1 - Large Lot Rural Residential to P3 - Parks and Open Space



This map is for general information only.
The City of Kelowna does not guarantee its accuracy. All information should be verified.

Rev. Tuesday, August 27, 2024

