

---

**LL22- 0021-  
4629  
LAKESHORE  
ROAD**

**BARN OWL  
BREWING CO.**

*JANUARY 17, 2023  
PUBLIC MEETING*

---

**BARN OWL BREWING CO.  
BARNOWLBREWING.CA**



IT'S...A BAKERY  
LUNCH & COFFEE

BARN OWL  
BREWING CO

OPEN  
COME ON IN



Reserved

BARN OW BREWING CO.  
Place dirty glassware in the TRAY please!

OUTHOUSE

WICOMENFARM LTD DE ROCHE



OUTHOUSE

Hungry?  
Order  
with  
us!

Bring your own food  
Plates and utensils  
MONOPOLY  
LOTS OF GAMES  
Our tops are always changing...  
JORE  
Dashed the "what's new" chalkboard

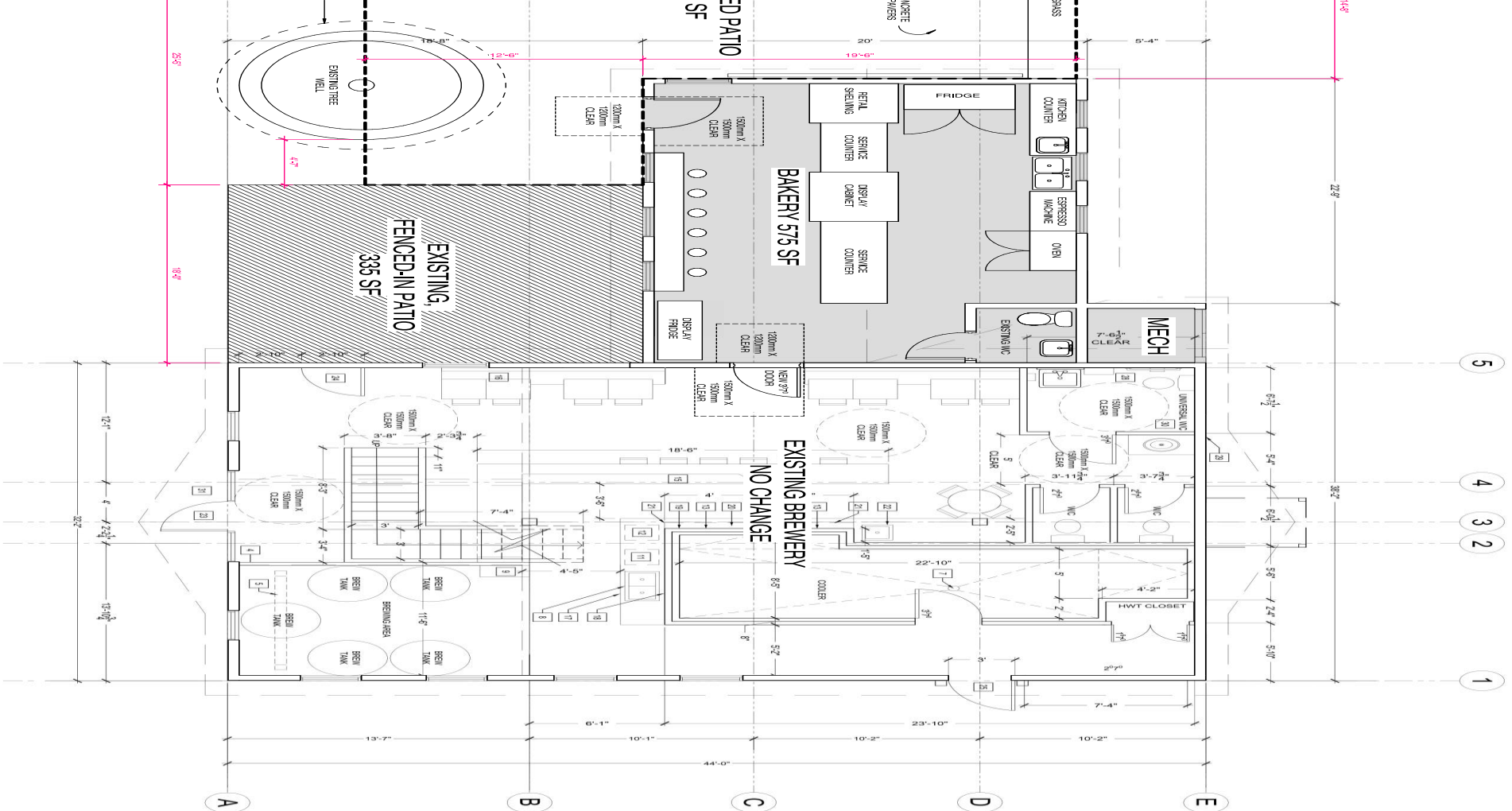

NOTES (EXISTING):

- 1 42" AFFR TABLE ON SEATING
- 2 1 1/2" STEEL TOP RAIL ON SHEET GLASS PANELS, SUPPORT POSTS ATTACHED TO SIDE OF STAIR STRINGERS
- 3 SLOPED & SEALED CONCRETE FLOOR ON TROMEL FINISH, TO BE SLOPED TOWARDS FLOOR DRAIN
- 4 #4 REBAR WILL COMPOSED OF:
  - 1/2 GRID TYPED & SEALED PAINTED.
  - 2X6 STUDS AT 8" O.C.
  - 1/2 GRID TYPED & SEALED PAINTED
  - MILLWORK SILL TO BE INSTALLED ON TOP OF ROW WALL @ 4" AFF
  - GLAZING SYSTEM TO BE INSTALLED ON TOP OF MILLWORK SILL TO 8" AFF
- 5 HOUS SYSTEM FROM BREWERY, TO BE INSTALLED PER MANUFACTURERS SPECIFICATIONS
- 6 BAR DOOR HUNG ON EAST SIDE OF ACCESS PANEL
- 7 FLOOR DRAIN CONNECTED TO SEWER SYSTEM
- 8 STAINLESS STEEL DOUBLE SINK ON 2" DRAIN CONNECTION TO SEWER SYSTEM
- 9 BEER CONTROLLER FROM BREWERY, TO BE INSTALLED PER MANUFACTURERS SPECIFICATIONS 200V / 50A 3 PHASE SERVICE & 200V / 30A SINGLE PHASE SERVICE REQUIRED
- 10 STAINED WOOD BAR ON BAR SEATING AND SUPPORT AS REQUIRED
- 11 DISHWASHER BELOW COUNTER
- 12 GLASS WASHER BELOW COUNTER
- 13 LOCATION OF BEER TAPS MOUNTED TO THE WALL, MOUNTING HEIGHT TO BE CONFIRMED, GLASS FILL TAPS AND BROWLER FILL TAPS TO BE SEPARATE
- 14 INSULATED WALK-IN COOLER ON INSULATED FLOOR SLAB
- 15 STAINLESS STEEL SERVICE COUNTER @ 8" AFF
- 16 BENCH SEATING ALONG WEST WALL
- 17 #1 WATER MAIN TO BE CONNECTED TO WATER FILTRATION SYSTEM
- 18 HOT WATER SOURCE, IN WALL MOUNTED HOSE BIB ACCESSIBLE VIA OPEN SPACE UNDER SINK COUNTER
- 19 BREWERY FEATURE WALL
- 20 STAINLESS STEEL COUNTER AND BACKSPLASH
- 21 PERFORATED METAL DRAINAGE GRATE BELOW BEER TAPS ON DRAIN CONNECTION TO SEWER SYSTEM
- 22 STAINLESS STEEL SINGLE SINK ON 2" DRAIN CONNECTION TO SEWER SYSTEM
- 23 MAIN ENTRANCE DOOR
- 24 SECONDARY ENTRANCE DOOR
- 25 SERVICE ENTRY DOOR
- 26 STORAGE ON SHELVEING
- 27 42" HIGH WOOD VENEER TABLES SECURED TO POINT WALL AND ON HIGH CHAIR SEATING
- 28 DROPPED GRID CEILING WITH HVAC UNITS ABOVE THE WASHROOMS, DISHIE HVAC UNITS ARE SEISMICALLY RESTRAINED.
- 29 FROSTING FILL UNITS IS SURFACE OF WINDOWS IN THE WASHROOMS

- 30 UNIVERSAL WASHROOM WITH CLEAR FLOOR SPACE OF NOT LESS THAN 44" WITH NO DIMENSION LESS THAN WIDTH IS 41" AND SERVED BY AN ACCESSIBLE PATH OF TRAVEL. REFER TO UNIVERSAL WASHROOM DETAIL PLAN ON SHEET A101
- 31 EXTERIOR WALK COMPLETE WITH A SLIP-RESISTANT CONTINUOUS AND LEVEL SURFACE TO BE NOT LESS THAN 150MM WIDE AND HAVE A LEVEL AREA CORRESPONDING TO 838C 2018 CLAUSE 3.8.13 (1) IN ADJACENT TO THE ENTRANCE DOORWAY.

MAIN FLOOR USAGE: TASTING ROOM  
OCCUPANT LOAD: 36

ROOM: 003-01  
SCALE: 1/4" = 1'-0"  
DRAWN:   
CHECKED:   
DATE: 4/29/14

ISSUES:   
DATE: JAN 07

REVISION:

DRAWN:   
LEVER:   
SCALE:   
TENN:   
BAR:   
BAR:





IT'S...A BAKERY  
LUNCH & COFFEE

BARN OWL  
BREWING CO

OPEN  
COME ON IN