



# Kelowna Community Campus

The Redevelopment of Parkinson Recreation Centre Site

## Project Framework

Monday 28<sup>th</sup> November 2022

# GUIDING PRINCIPLES FRAMEWORK



People focused



Good stewards



Innovative



Cultivate  
partnerships



Sustainable



## PEOPLE-FOCUSED AMENITIES



MYRTLE BEACH SPORTS CENTRE



WEST VANCOUVER COMMUNITY CENTRE



TIMMS COMMUNITY CENTRE - LANGLEY



**GOOD STEWARDS OF PUBLIC RESOURCES** – optimizing program while being fiscally responsible



MUBANE COMMUNITY PARK, MUBANE, NORTH CAROLINA



HILLCREST COMMUNITY CENTRE + RILEY PARK, VANCOUVER



## INNOVATIVE DESIGN LEADERSHIP



WEST VANCOUVER AQUATIC CENTRE + WEST VANCOUVER COMMUNITY CENTRE, ACTIVE MOVEMENT GYM



## CULTIVATE PARTNERSHIPS



WEST VANCOUVER COMMUNITY CENTRE



NEW WESTMINSTER COMMUNITY CENTRE



## SUSTAINABILITY



HILLCREST COMMUNITY CENTRE, VANCOUVER



WEST VANCOUVER COMMUNITY CENTRE

## PROCESS TO DATE







Reimagining Parkinson Recreation Centre



Watch later



Share

# Reimagining Parkinson Recreation Centre



City of  Kelowna

Watch on  YouTube

# Engagement

## Engagement Tactics and Data Examined



### Public Telephone Survey (2021)

300 interviews exploring public appetite for PRC redevelopment



### Stakeholder Discussion Sessions (2021)

5 sessions with 13 stakeholder groups



### Online Group Survey (2021)

45 responses from PRC user groups surveyed online



### Partner Interviews (2021)

6 robust discussions



### Cultural Engagement Findings

Cultural Facilities Master Plan engagement data reviewed



### Public Survey (2022)

“Get Involved” survey with Q&A and discussion forum



### Info Sessions (2022)

2 information sessions at PRC



## PUBLIC SURVEY – RANKING OF GUIDING PRINCIPLES

<b>People-focused amenities:</b> health wellness and competitive opportunities; inclusive and multigenerational	1
<b>Sustainability:</b> pedestrian campus feel that incorporates connectivity of multi-modal transportation; respect Mill Creek floodplain; commitment to reducing GHG's	2
<b>Good stewards of public resources:</b> Optimizing amenities balanced with fiscal responsibility; considerate of operation through construction	3
<b>Cultivating partnership:</b> Ensure opportunities to collaborate with partners including Indigenous communities, and school district	4
<b>Innovative leadership:</b> design fosters community pride; sets bold sustainability targets	4

## Support for Building New Recreation Facility to Replace Parkinson Recreation Centre

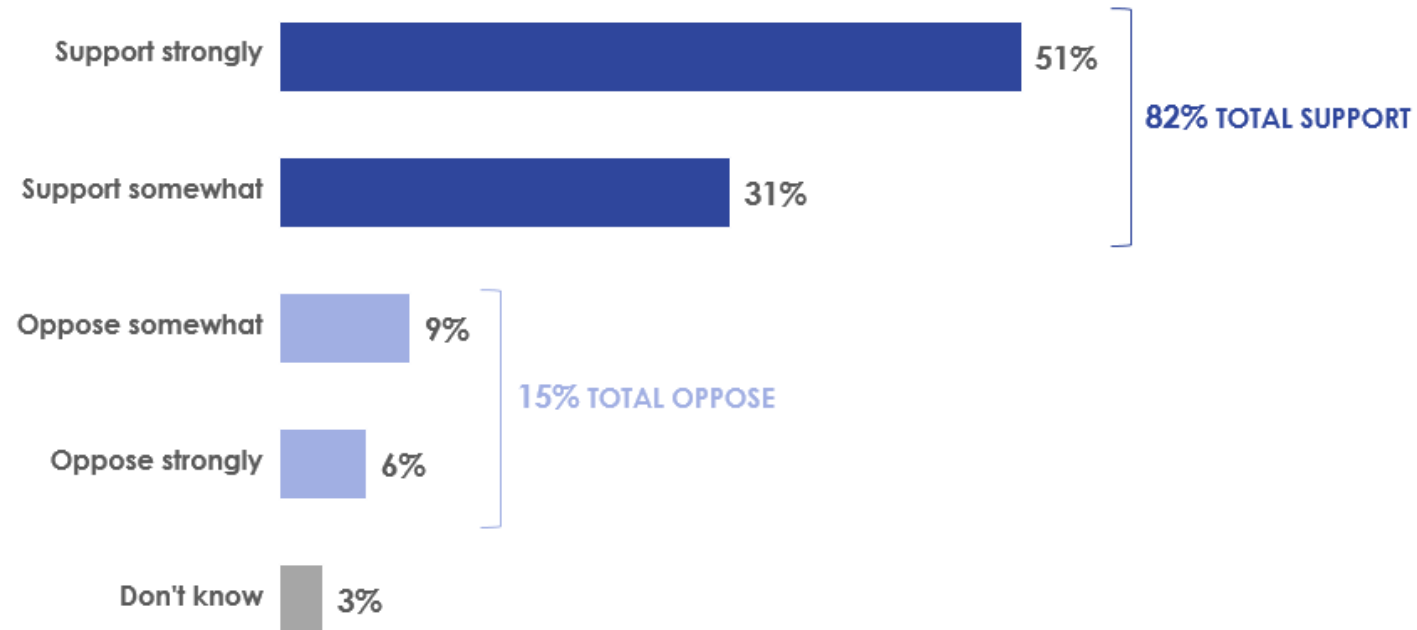

Base: All respondents (n=300)

Q8. In general, do you support or oppose building a new publicly owned recreation facility in Kelowna that would replace the Parkinson Recreation Centre? (Is that strongly or somewhat support/oppose?)



## Support for Property Tax Increase to Help Fund Construction of New Recreation Facility to Replace Parkinson Recreation Centre

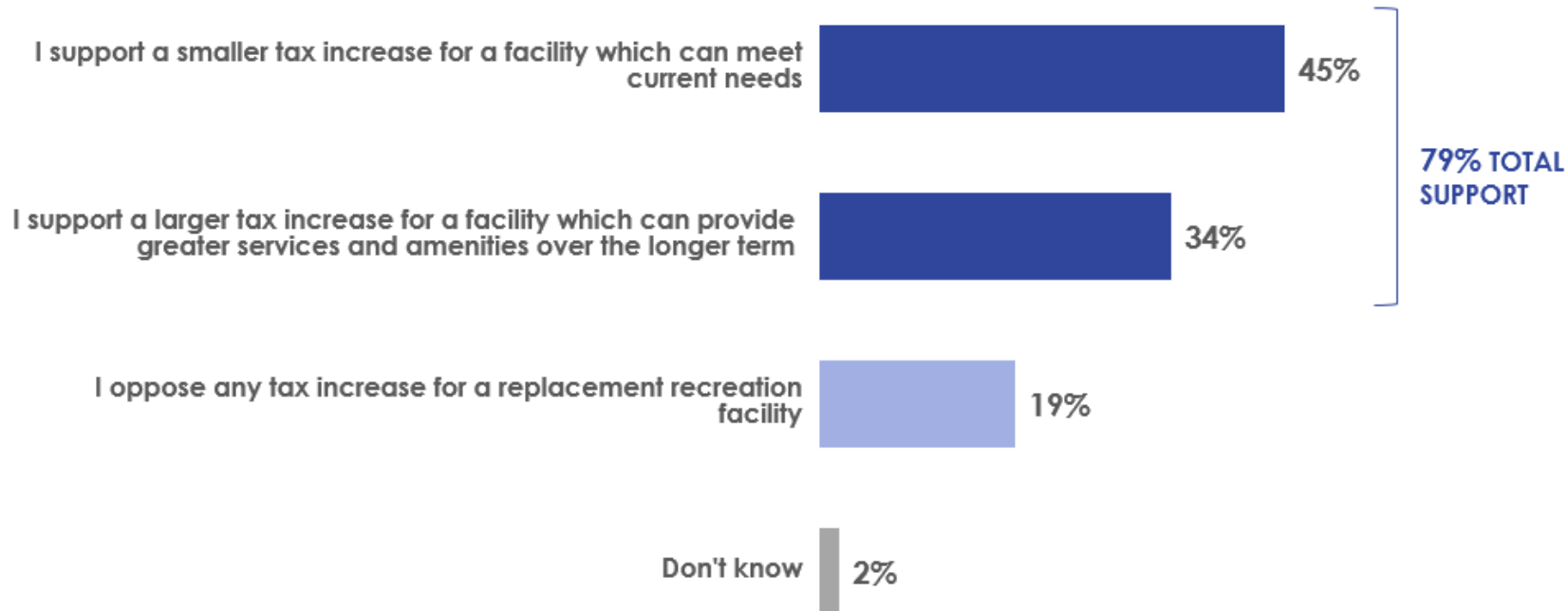

Base: All respondents (n=300)

Q14. Which one of the following statements best represents your view towards a property tax increase to help fund the construction of a new recreation facility to replace the Parkinson Recreation Centre?

2021: Functional program, survey and  
stakeholder engagement



2022 Council tour  
“Get it right” directive



2022: Confirmation of building location, guiding  
principles and public engagement completed



2023: Confirmation of revised  
functional program



# Aquatic Centre

Health and wellness focus

- ▶ 25m Lap Pool
- ▶ Family Leisure Pool
- ▶ Sauna
- ▶ Hot Tubs
- ▶ Cold Plunge

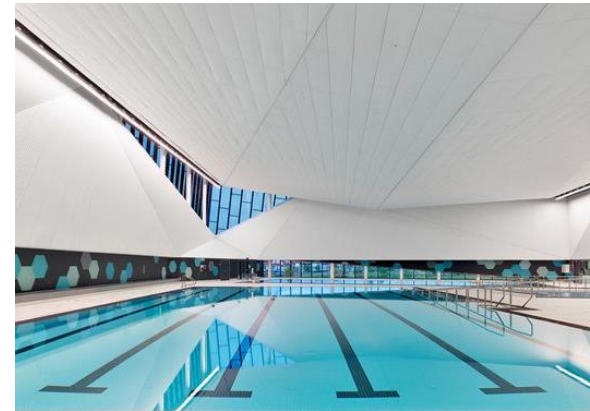
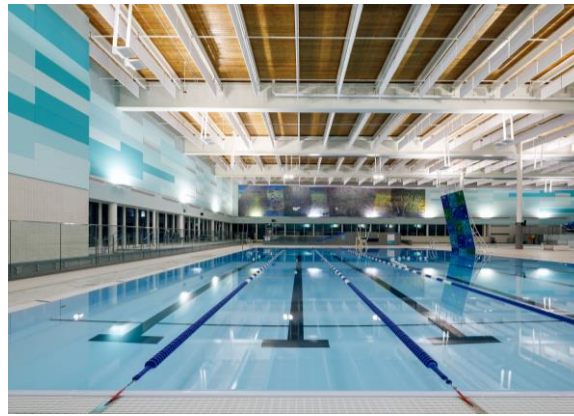



# Athletic Components

## Community Focused Athletics

- ▶ Triple Gym Complex
- ▶ Walking / Running Track
- ▶ Fitness Centre





# General Program Spaces

## Community Focused Programming

- ▶ Large Flexible Spaces
- ▶ Complimentary Support Amenities





# Creating a True Community Hub





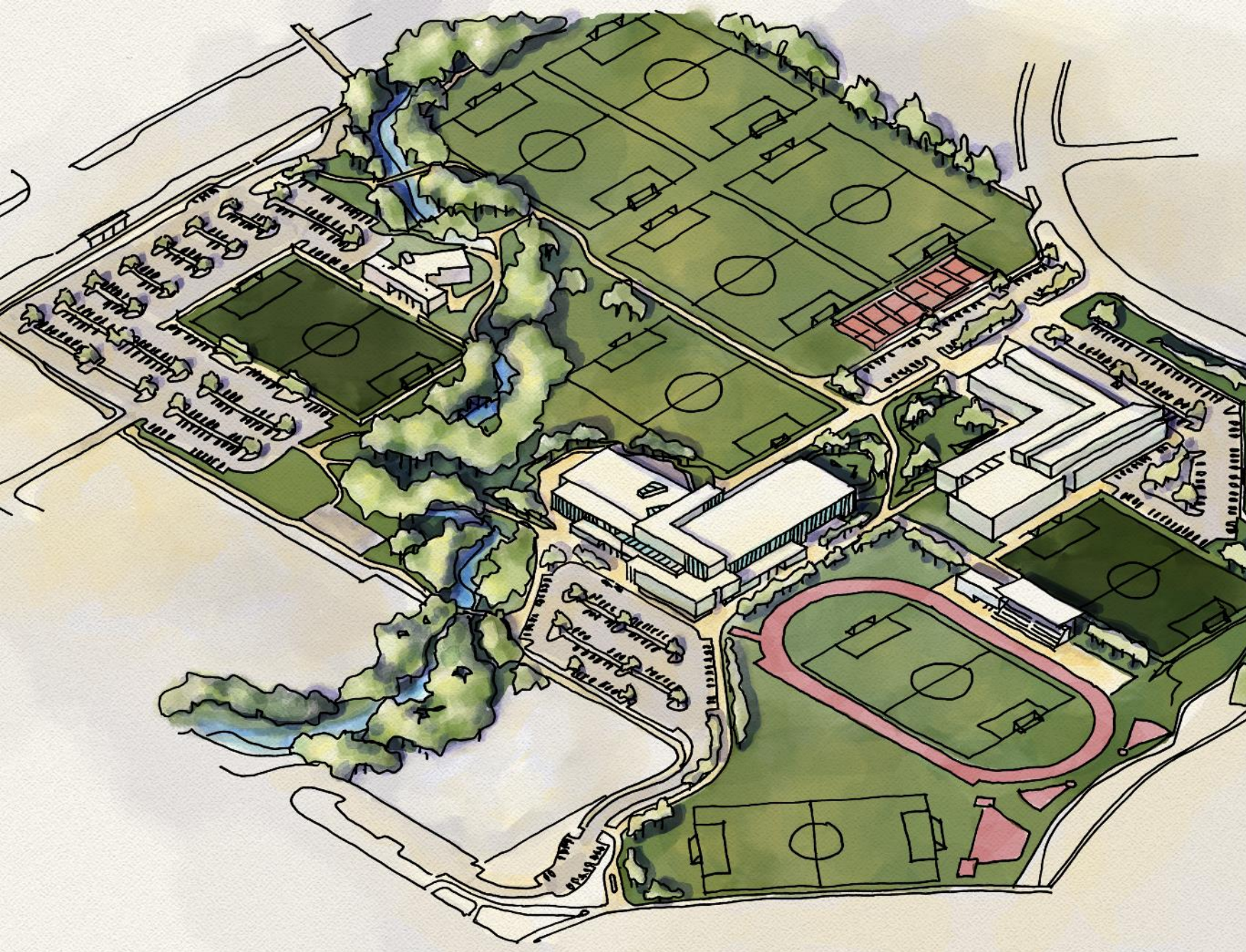

CO-LOCATED CAMPUS MODEL –  
A PARK SETTING



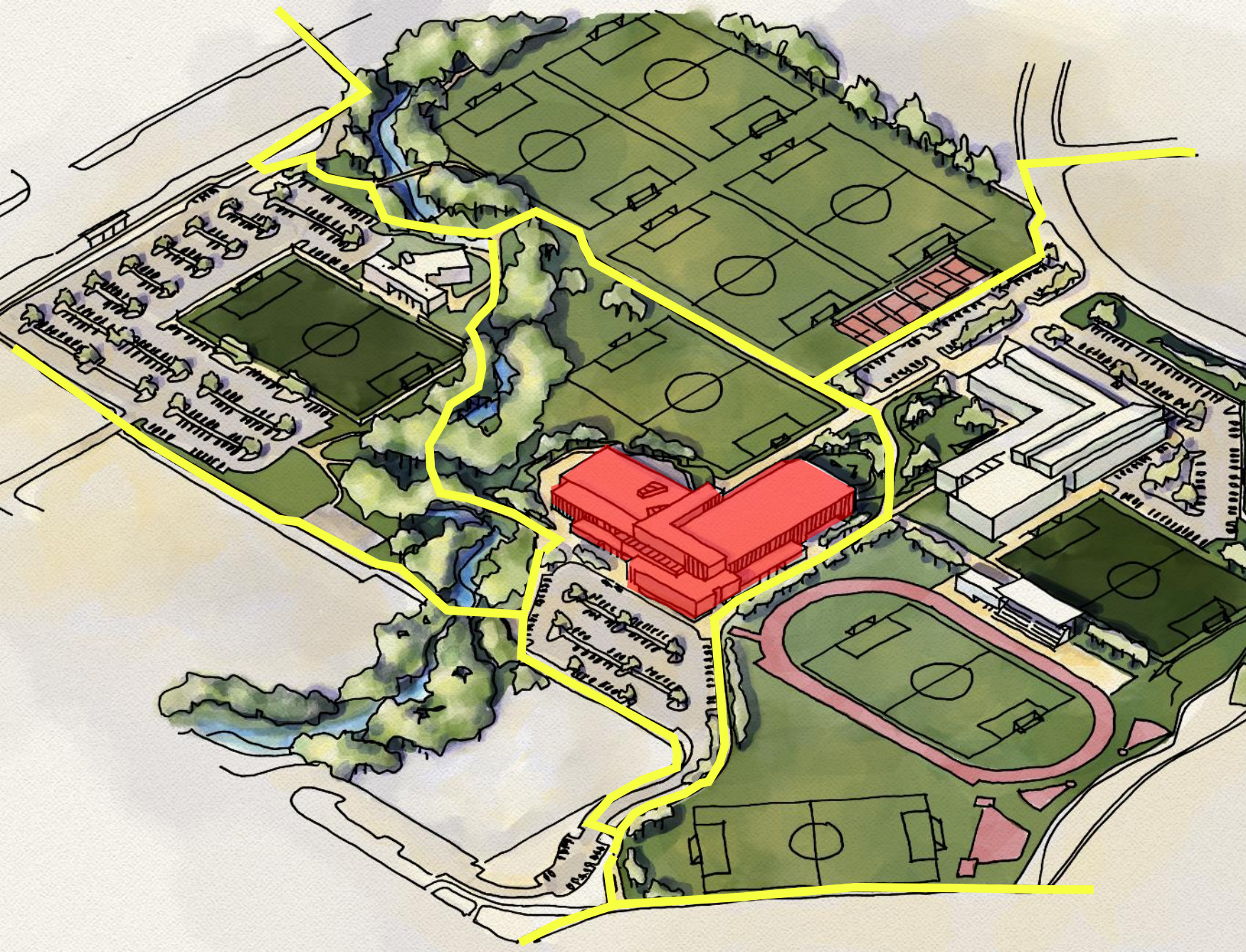

PARK LINKAGE THROUGH  
PEDESTRIAN AND CYCLING  
CORRIDORS



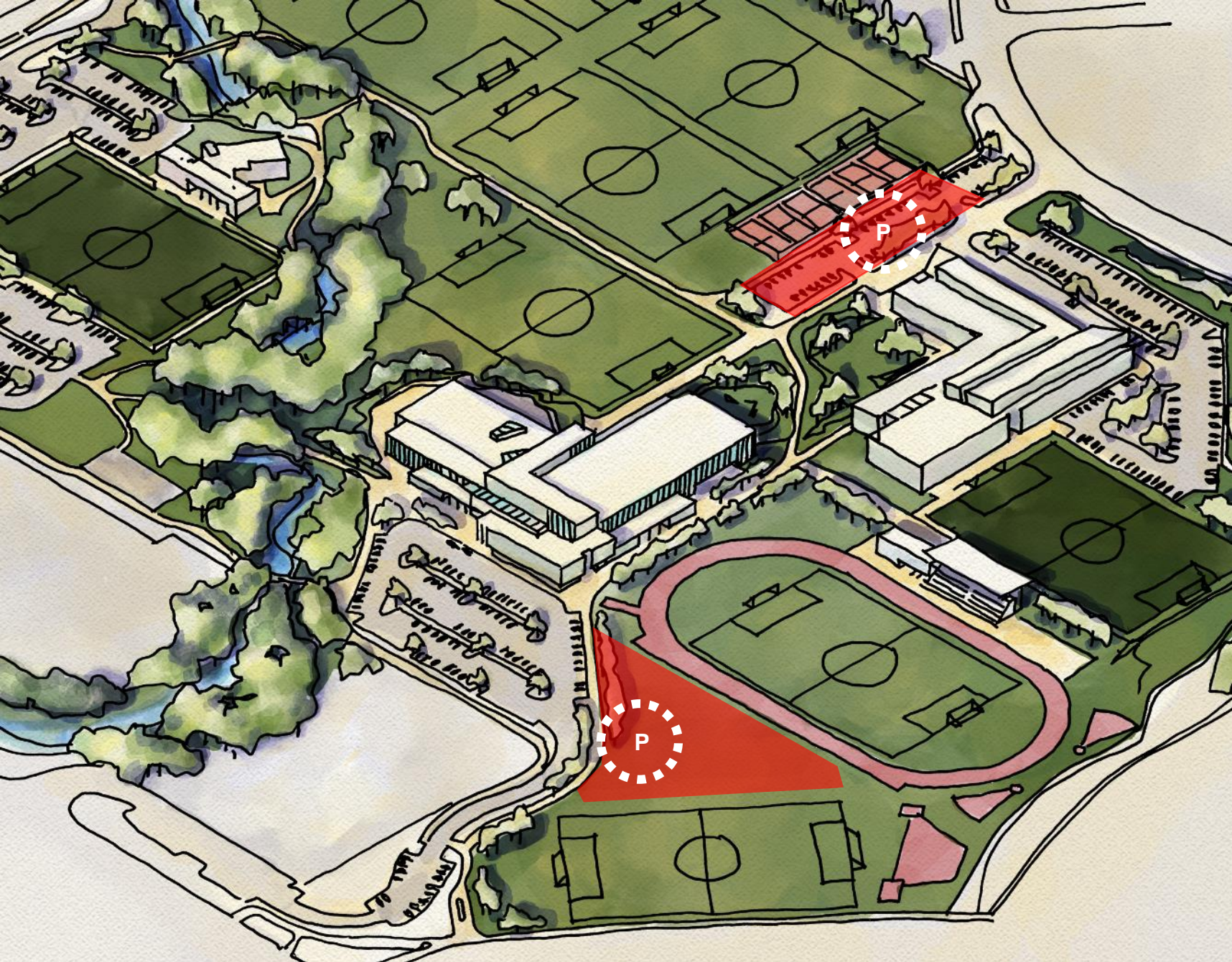

CO-LOCATED CAMPUS MODEL –  
ADDITIONAL PARKING OPPORTUNITY



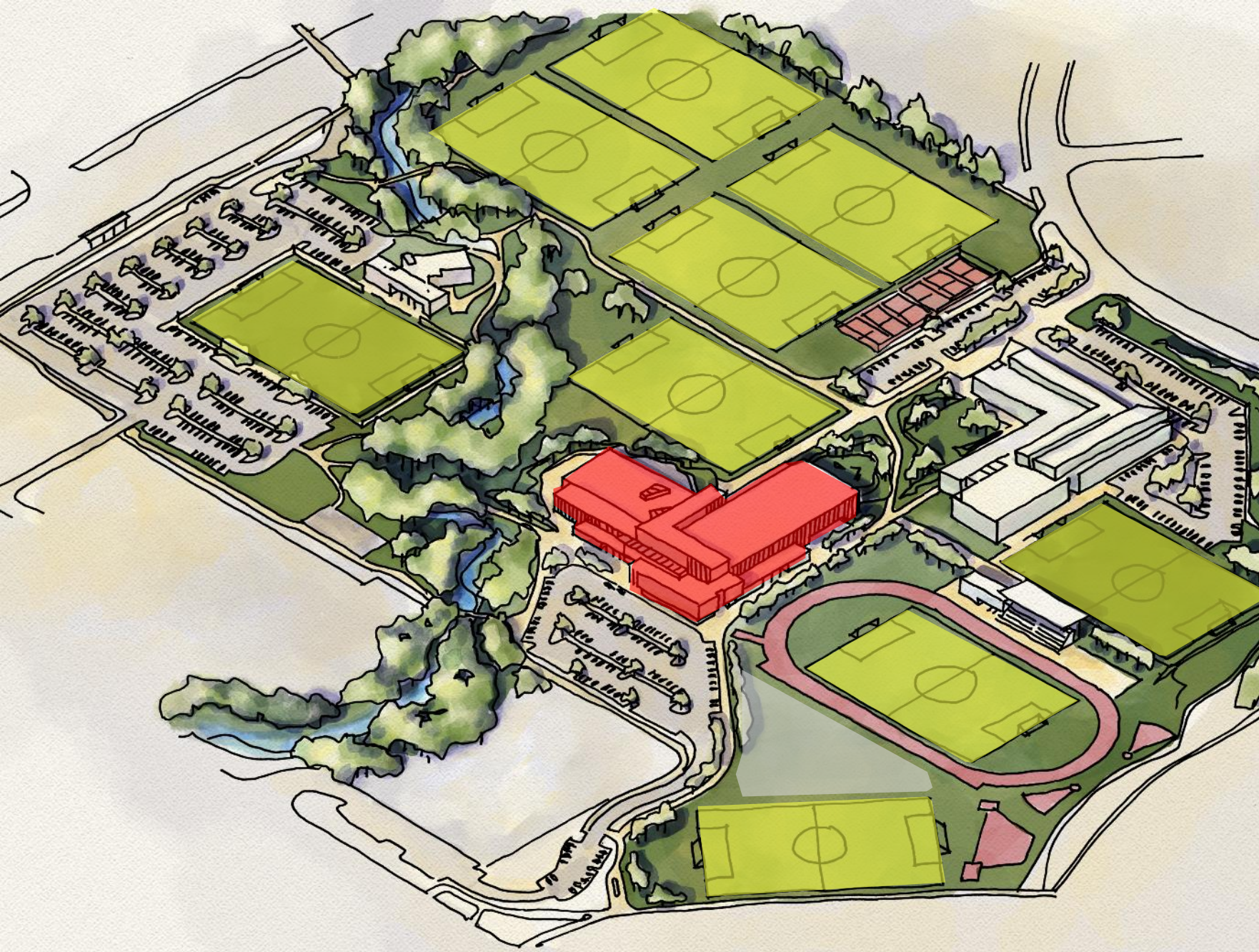

CO-LOCATED CAMPUS MODEL –  
OUTDOOR TOURNAMENTS



CO-LOCATED CAMPUS MODEL –  
CONNECTION TO ATHLETIC TRACK



# CONNECTION TO TRACK AND TURF FIELDS



MINORU CENTER FOR ACTIVE LIVING, RICHMOND BC





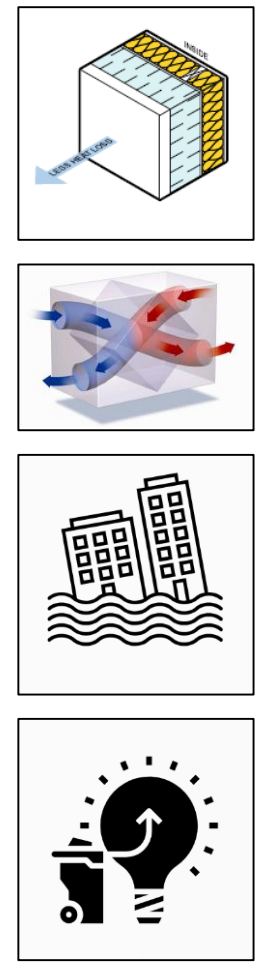
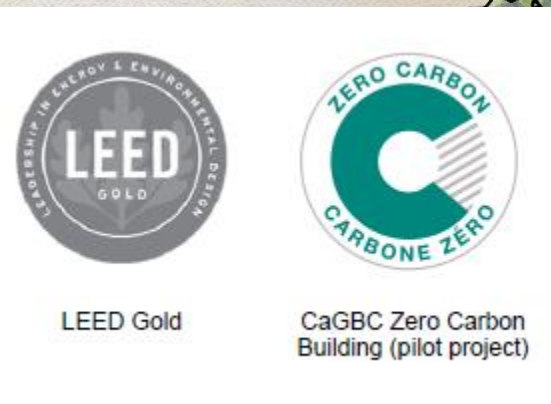

SUSTAINABILITY



