

Z22-0018
467 Collett Road
Rezoning Application

Proposal

- ▶ To consider an application to rezone the subject property from RU1 – Large Lot Housing zone to the RU1c – Large Lot Housing with Carriage House zone.

Development Process



Context Map

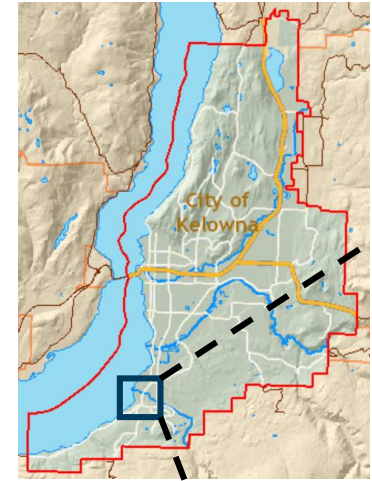

City of Kelowna

OCP Future Land Use / Zoning

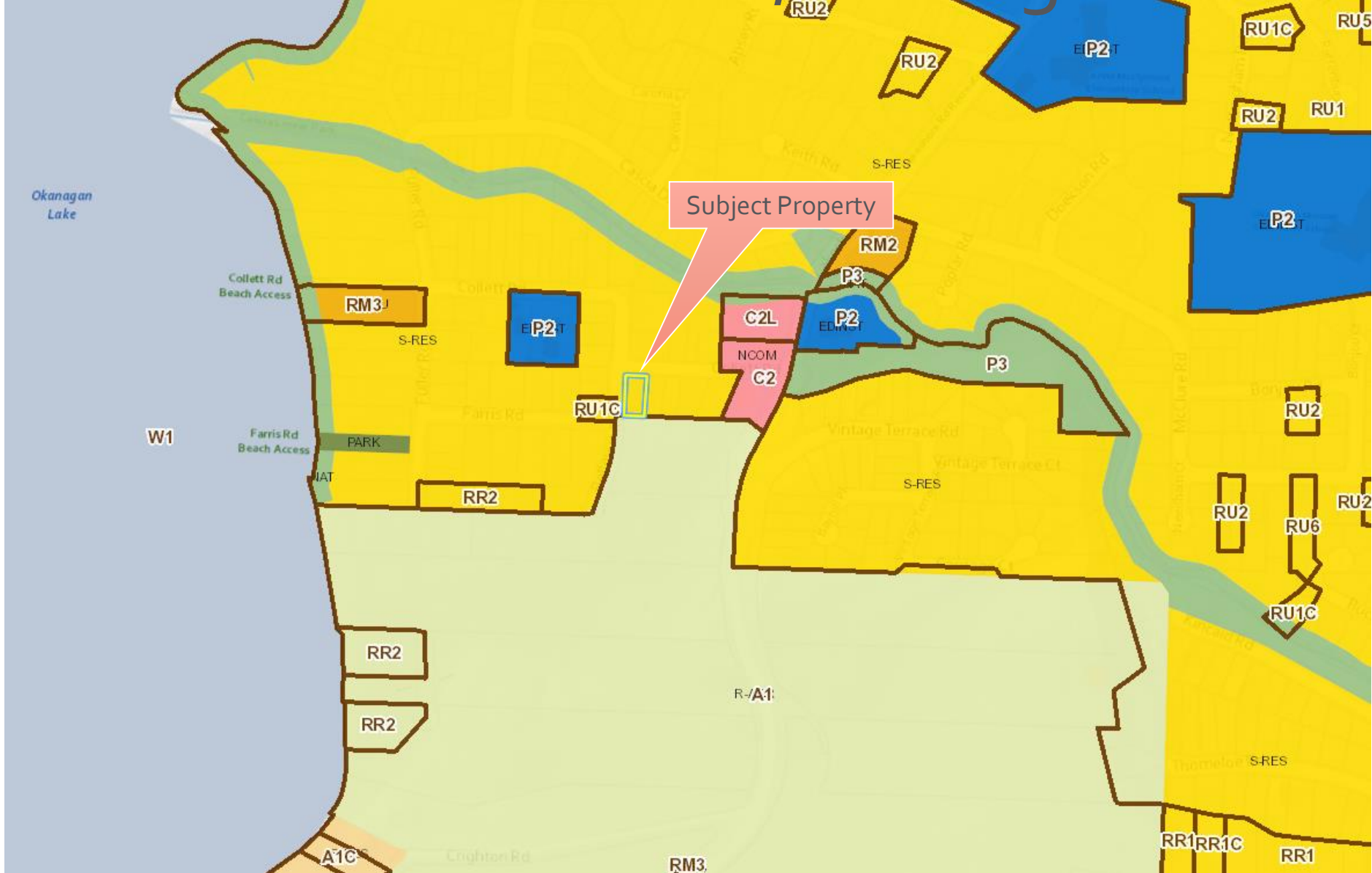

City of Kelowna

Subject Property Map



City of Kelowna

Project Details

- ▶ The proposed rezoning from the RU1 – Large Lot Housing zone to the RU1c – Large Lot Housing with Carriage House zone.
- ▶ Would facilitate the construction of a carriage house behind the principal dwelling.
- ▶ Property borders the ALR, which requires the construction of a 4-metre landscape buffer.

Site Plan

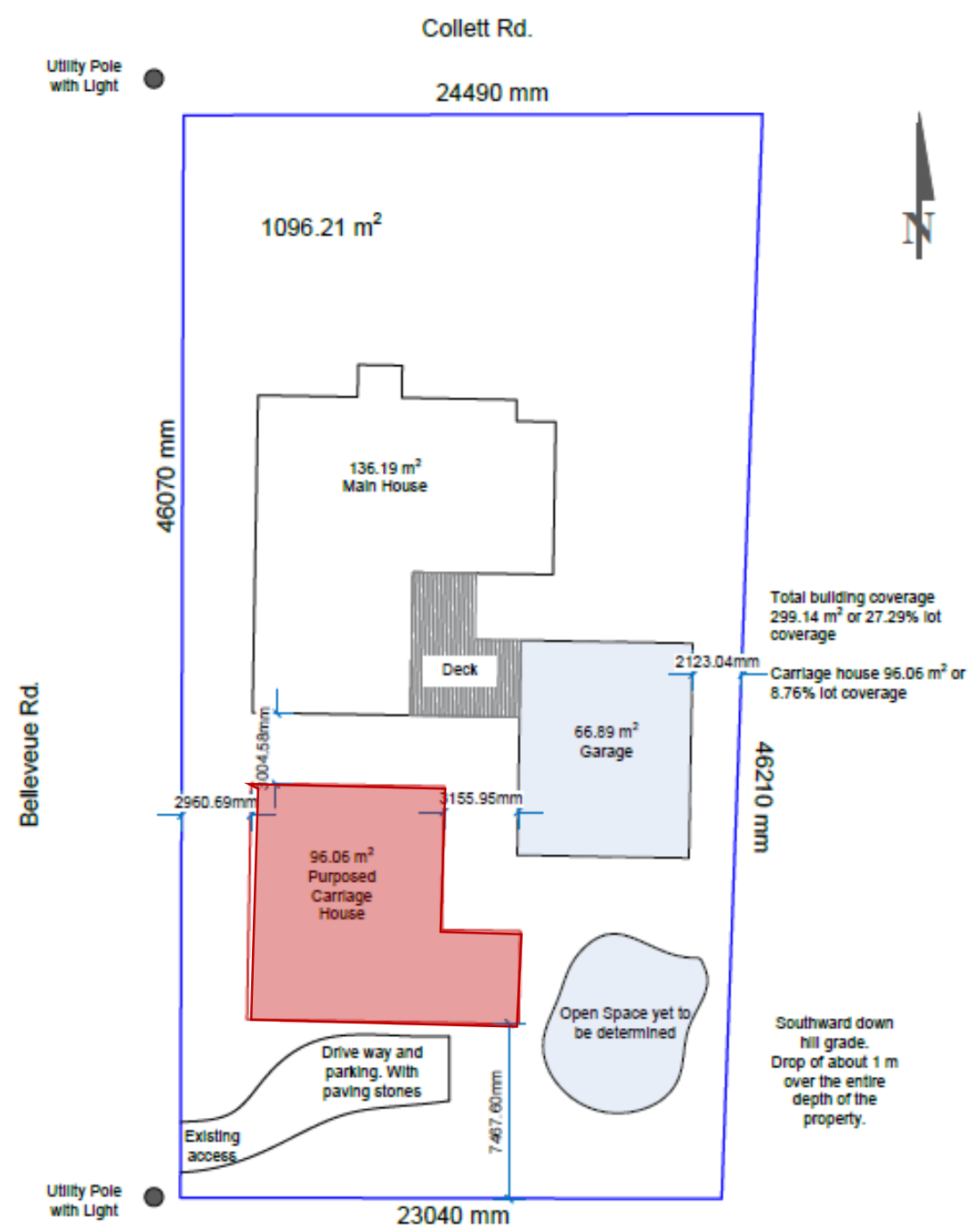

Development Policy

- ▶ Meets the intent of Official Community Plan Suburban Residential Policies by providing modest residential growth within existing neighbourhoods
 - ▶ Proposed Carriage house would provide an additional ground-oriented dwelling contributes to diverse and affordable housing within suburban neighbourhoods.
 - ▶ Provides an additional dwelling unit on a site near multiple schools.

Staff Recommendation

- ▶ Staff recommend **support** of the proposed rezoning to the RU1c – Large Lot Housing with Carriage House zone:
 - ▶ Consistent with the surrounding neighbourhood uses.
 - ▶ Future Land Use designation of S-RES supports the RU1c zone.



Conclusion of Staff Remarks