



Marriott Courtyard

3508 & 3480 Fleet Court,
Kelowna BC
OCP amendment (20-0003)
and Rezone (Z20-0006)



Argus Properties Ltd.
300-1060 Manhattan Drive
Kelowna, BC V1Y 9X9

About Argus

- A full service development, construction, property management and hospitality leader serving the Kelowna market for over 50 years.
- One of the most diversified and largest private employers, supporting over 600 employees in the region.
- Long-standing community relationships and partnerships with many local organizations through philanthropic donations and business interests.
- Varied portfolio of businesses and property: industrial, office, retail, commercial, hotels, restaurants, multi-family, and agricultural



Argus and the Gateway Area

- More than 500,000 guests stays in the Airport District
- Generated over \$9m in tax revenue for the city and airport district
- Contributed over \$300k in YLW advertising over the last five years
- More than \$2.3m spent promoting hotels at the Airport District & local tourism



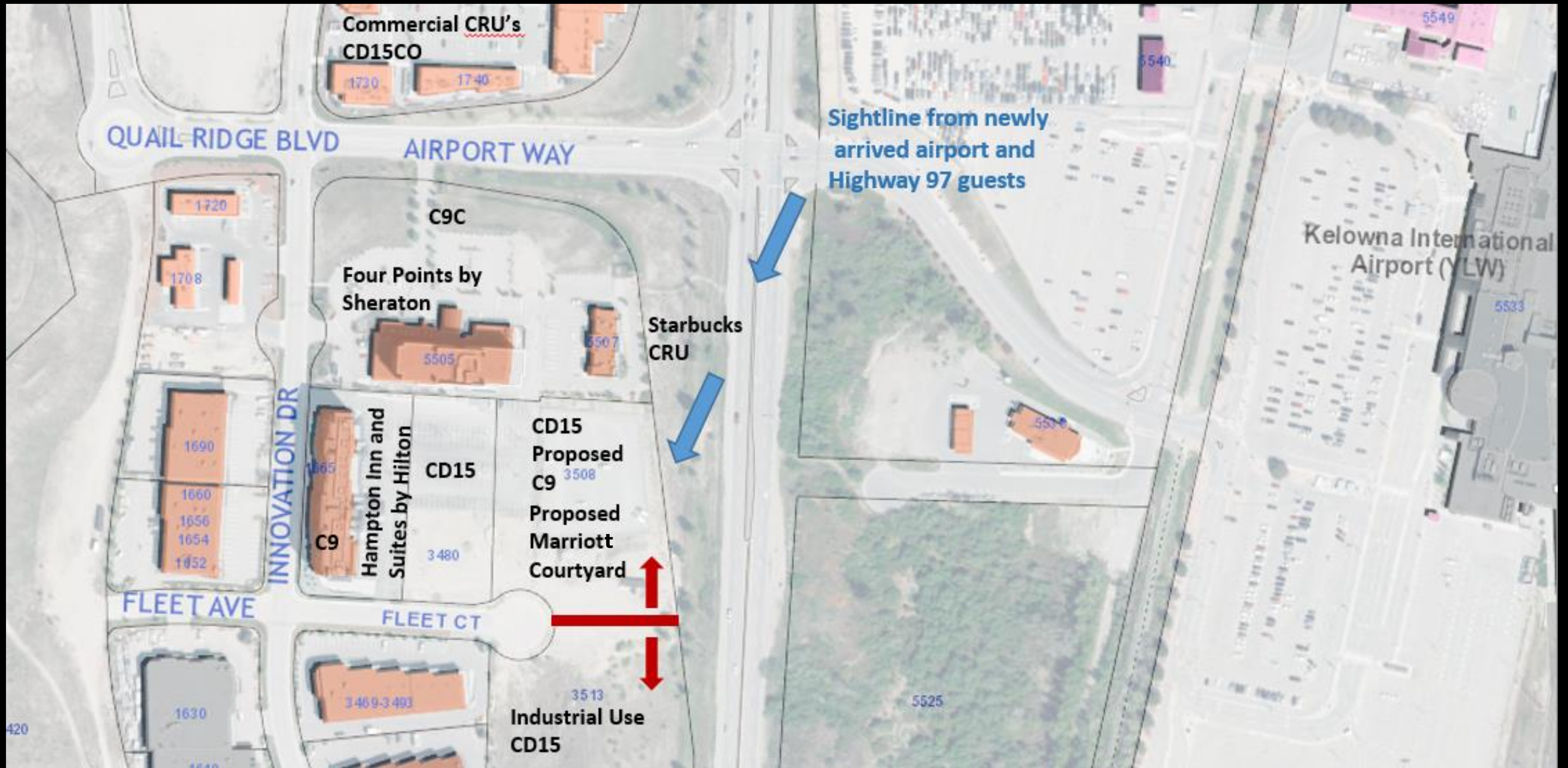

Project Overview

- Addition of a Courtyard by Marriott will complete the first class hotel offering at our Airport Hotel Campus
- Our project will support an identified need in the area



Community Plan and Policy Alignment

Objective 4.14

Protect the rental stock in Urban Centers.

Policy 4.14.3

Ensure short-term rental accommodations limits impact on the long-term rental housing supply.

Objective 6.3

Support the strategic and planned growth of Kelowna International Airport as a regional economic generator.

Objective 6.5

Encourage initiatives in the Gateway that supplement local food system to increase food security, equitable access to healthy food, and social connections.

Argus Hotel Portfolio



FOUR POINTS
BY SHERATON
Kelowna Airport



Hampton Inn & Suites
by HILTON



COURTYARD[®]
Marriott[®]



HOTEL ELDERADO
ELDERADO RESORT



MANTEO
ELDERADO RESORT



HOME 2
SUITES BY HILTON





**COURTYARD CHARLOTTE STEELE CREEK
CHARLOTTE, NC**



COURTYARD SEATTLE NORTHGATE
SEATTLE, WA



COURTYARD AMES
AMES, IA



**COURTYARD PASCO TRI-CITIES AIRPORT
PASCO, WA**



COURTYARD MONTREAL BROSSARD
BROSSARD, QUEBEC



COURTYARD THOUSAND OAKS AGOURA HILLS
AGOURA HILLS, CA

Argus Properties Ltd.
300-1060 Manhattan Drive
Kelowna, BC V1Y 9X9



(250) 763-6789
info@argusproperties.ca