

PROPOSED SUBDIVISION PLAN OF LOT 19 SECTION 26
TOWNSHIP 26 OSOYOOS DIVISION YALE DISTRICT PLAN 15377

CITY OF KELOWNA
CIVIC ADDRESS: 140 MUIR ROAD
PID: 008-836-914

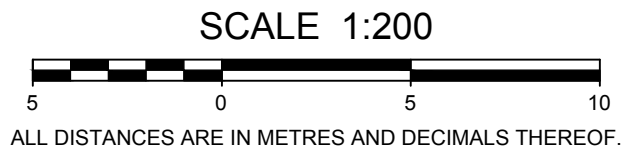

THE INTENDED PLOT SIZE OF THIS PLAN IS 280mm IN WIDTH BY 432mm IN HEIGHT (B SIZE) WHEN PLOTTED AT A SCALE OF 1:200

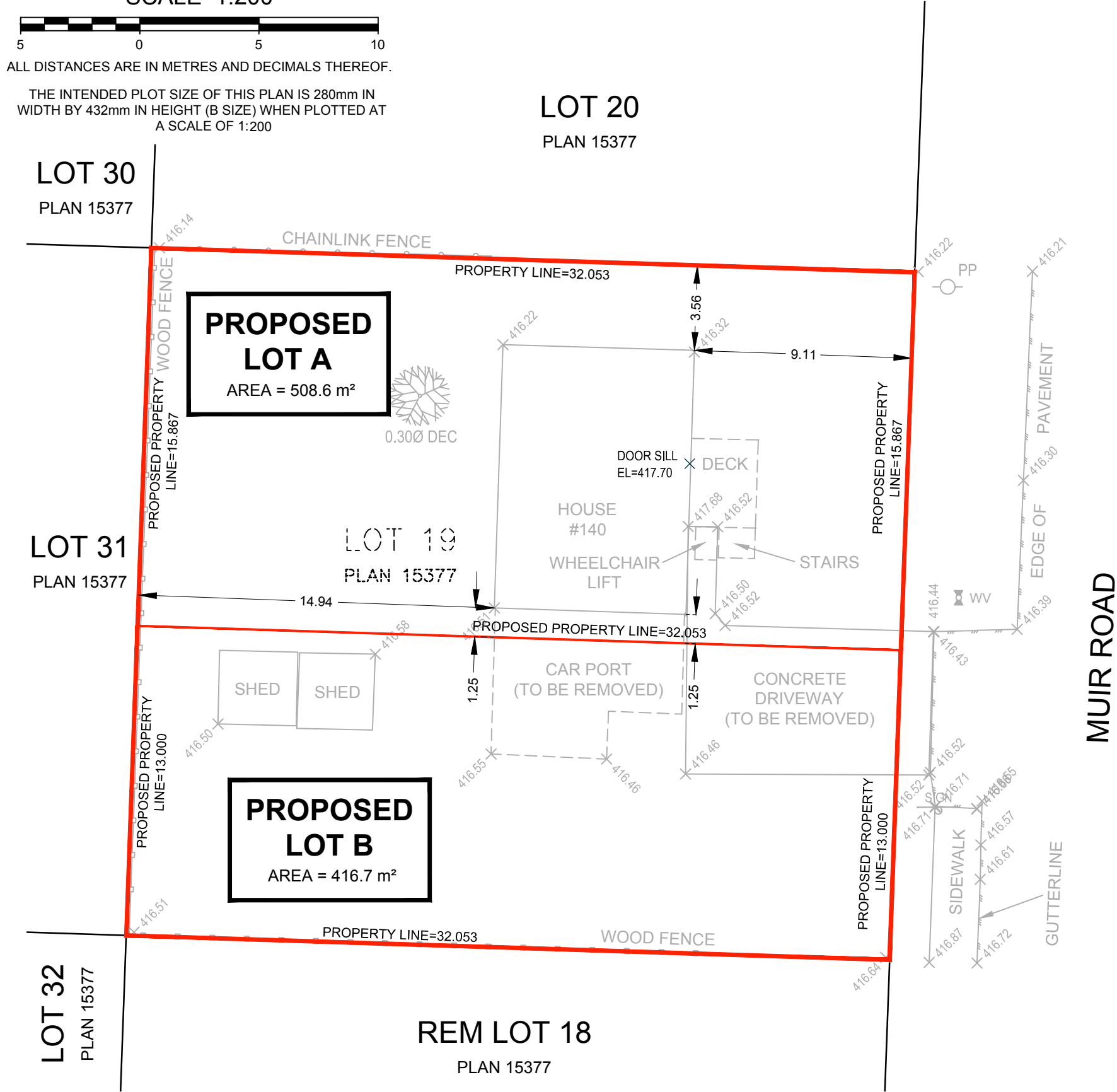

ATTACHMENT A

This forms part of application
Z22-0016

Planner Initials **MT**

City of Kelowna
COMMUNITY PLANNING

ZONING: RU1

PROPERTY DIMENSIONS SHOWN ARE DERIVED FROM: FIELD SURVEY

OFFSETS TO PROPERTY LINES ARE NOT TO BE USED TO DEFINE BOUNDARIES.

REFER TO CURRENT CERTIFICATE(S) OF TITLE FOR ADDITIONAL, EXISTING OR PENDING CHARGES.

THIS PLAN SHOWS THE LOCATION OF VISIBLE FEATURES ONLY, AND DOES NOT INDICATE BURIED SERVICES THAT MAY EXIST ON OR AROUND THE SUBJECT SITE.

FEATURES SHOWN WITHOUT DIMENSIONS SHOULD BE CONFIRMED WITH BENNETT LAND SURVEYING LTD.

bennett ©
LAND SURVEYING LTD.
BC LAND SURVEYORS
#201 - 1470 ST. PAUL STREET,
KELOWNA, BC
V1Y 2E6
TEL 250-763-5711
www.bennettsurveys.com

ELEVATIONS ARE TO CGVD28 GEODETIC DATUM, AND ARE DERIVED FROM DUAL-FREQUENCY GNSS OBSERVATIONS PROCESSED USING THE SMARTNET REAL-TIME NETWORK SERVICE.

THIS PLAN HAS BEEN PREPARED FOR CONSTRUCTION PURPOSES ONLY AND IS FOR THE EXCLUSIVE USE OF OUR CLIENT.

ALL RIGHTS RESERVED. NO PERSON MAY COPY, REPRODUCE, TRANSMIT OR ALTER THIS DOCUMENT IN WHOLE OR IN PART WITHOUT THE CONSENT OF BENNETT LAND SURVEYING LTD..

BENNETT LAND SURVEYING LTD. ACCEPTS NO RESPONSIBILITY OR LIABILITY FOR ANY DAMAGES THAT MAY BE SUFFERED BY A THIRD PARTY AS A RESULT OF ANY DECISIONS MADE, OR ACTIONS TAKEN BASED ON THIS DOCUMENT.

FINAL DIMENSIONS AND AREAS OF NEW LOTS SUBJECT TO MINOR CHANGES UPON COMPLETION OF LEGAL SURVEY.

FIELD SURVEY COMPLETED ON JULY 22, 2021.