

FAWN RUN DR

BUCKHAVEN CT

STEELE RD

ATTACHMENT A
 This forms part of application
 # Z21-0036
 Planner Initials **MT**



City of
Kelowna
DEVELOPMENT PLANNING

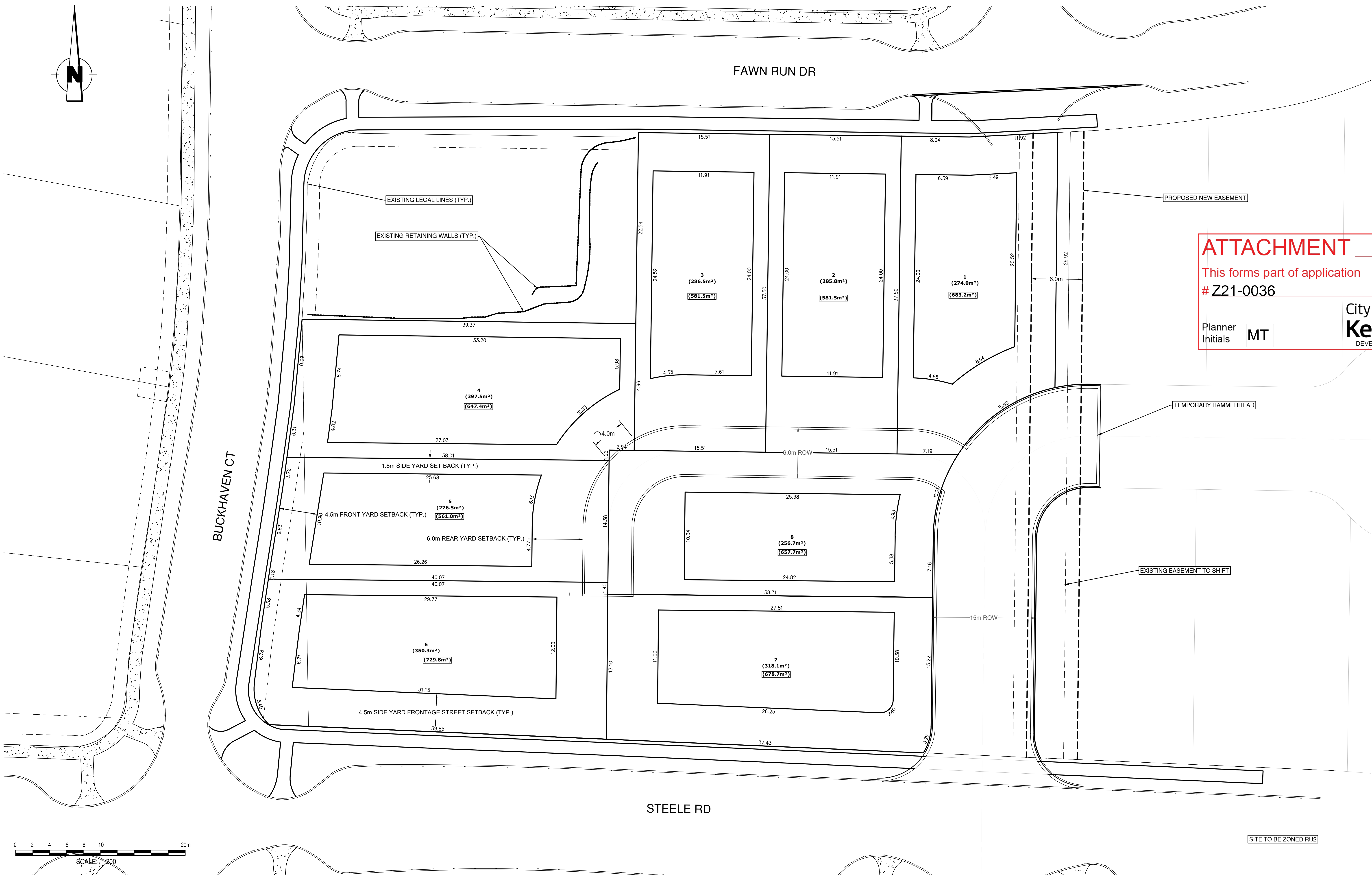

LEGEND

(350.0m ²)	BUILDING PAD AREA
(350.0m ²)	TOTAL LOT AREA



SUITE 700-1631 DICKSON AVENUE
 KELOWNA, B.C. V1Y 0B5
 T. 250.980.5500, www.wsp.com

NO.	YY/MM/DD	BY	REVISION	CH'KD
A	21/03/26	HH	ISSUED FOR PLR	KK

BASE	DESIGN
NS	NS
APPROVED	KK
DATE	FEB, 2021
SCALE	H 1:200 V -
SCALE NOT ACCURATE OVER LONG DISTANCES	

THE CITY OF KELOWNA
 DESIGN AND CONSTRUCTION

BUCKHAVEN
 PARCEL DIMENSION PLAN

DIVISION	CIVIL
DRAWING NO.	REV NO.
C100	A

FILE LOCATION: P:\2021\Z21-0036\21-03-26 - Buckhaven - Development\3 - REVISED\3 - PARCELS - PLAN - 210326.dwg
 PRINTED ON: March 26, 2021