

CITY OF KELOWNA

BYLAW NO. 12259

Z21-0010

1870 Mantle Court, 2903 Walburn Road, 2975 Gallagher Road

A bylaw to amend the "City of Kelowna Zoning Bylaw No. 8000".

The Municipal Council of the City of Kelowna, in open meeting assembled, enacts as follows:

1. THAT City of Kelowna Zoning Bylaw No. 8000 be amended by changing the zoning classification of portions of:
 - a) Parcel A, Section 7, Township 27, ODYD, Plan KAP79441, located on Mantle Court, Kelowna, B.C.; and
 - b) The South West $\frac{1}{4}$ of Section 12, Township 26, ODYD, Except Plans 1380, B6800 and 20506, located on Walburn Road, Kelowna BC.
 - c) Lot A, Section 12, Township 26, ODYD, Plan EPP71625, located on Gallagher Road, Kelowna B.from the P₃ – Parks and Open Space and A₁ – Agriculture 1 zones to the A₁ – Agriculture 1 and P₃ – Parks and Open Space zones as shown on Map "B" attached to and forming part of this bylaw.
2. This bylaw shall come into full force and effect and is binding on all persons as and from the date of adoption.

Read a first time by the Municipal Council this

Considered at a Public Hearing on the

Read a second and third time by the Municipal Council this



Adopted by the Municipal Council of the City of Kelowna this

Mayor

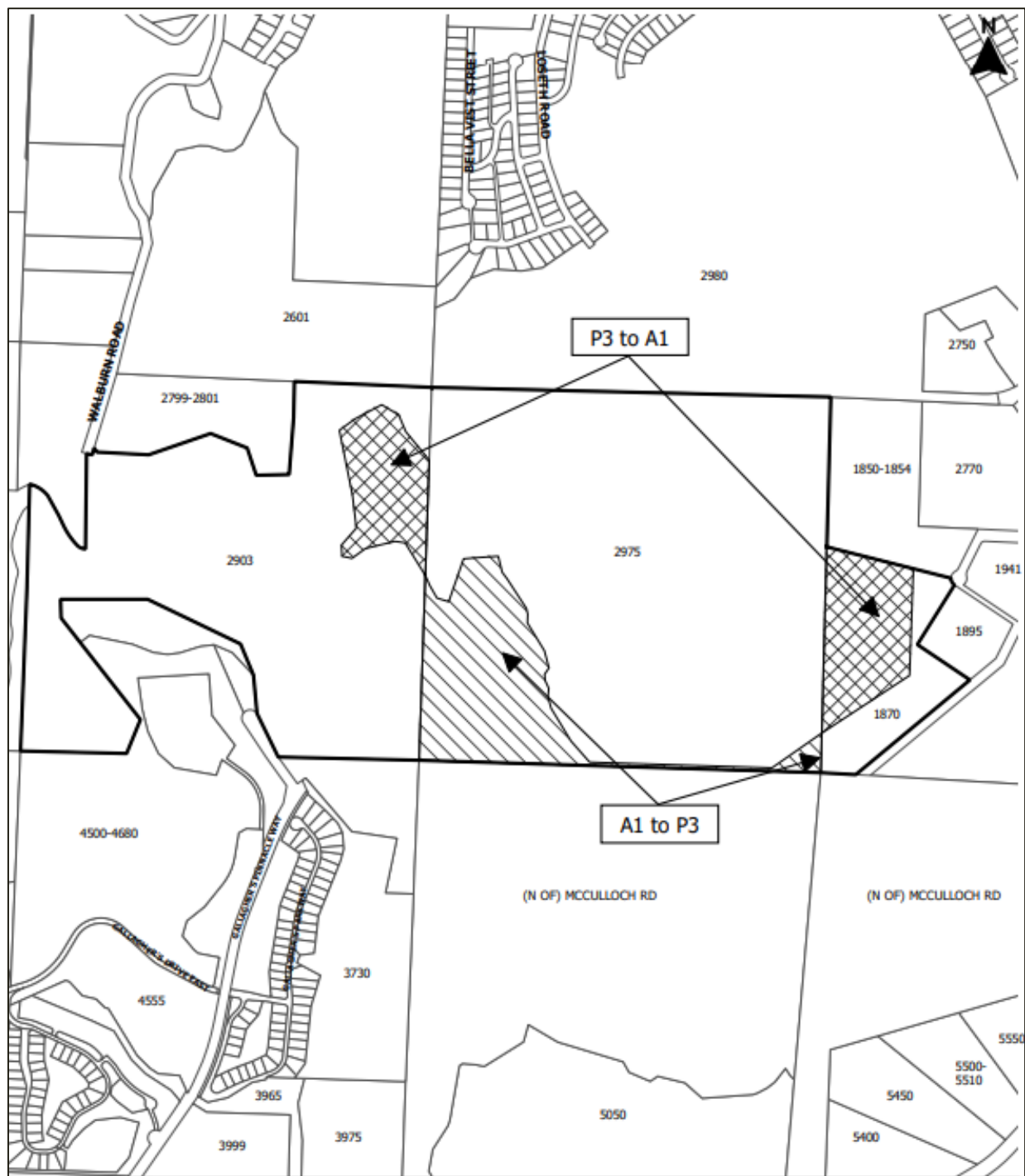
City Clerk



MAP "B" REZONING File Z21-0010

-  A1 - Agriculture 1 to P3 - Parks and Open Space
-  P3 - Parks and Open Space to A1 - Agriculture 1
-  Subject Properties



0 500 1,000 1,500 2,000 km

