

This forms part of application

# L21-0006

Planner Initials LK



201-75 FRONT STREET  
 PEKIN, B.C.  
 V2A 1H2  
 TEL: 250.492.3143  
 EMAIL: gen-mail@shaw.ca

233 BERNARD AVENUE  
 KELOWNA, B.C.  
 V7Y 6N2  
 TEL: 250.762.2004  
 EMAIL: tel-mkt@shaw.ca

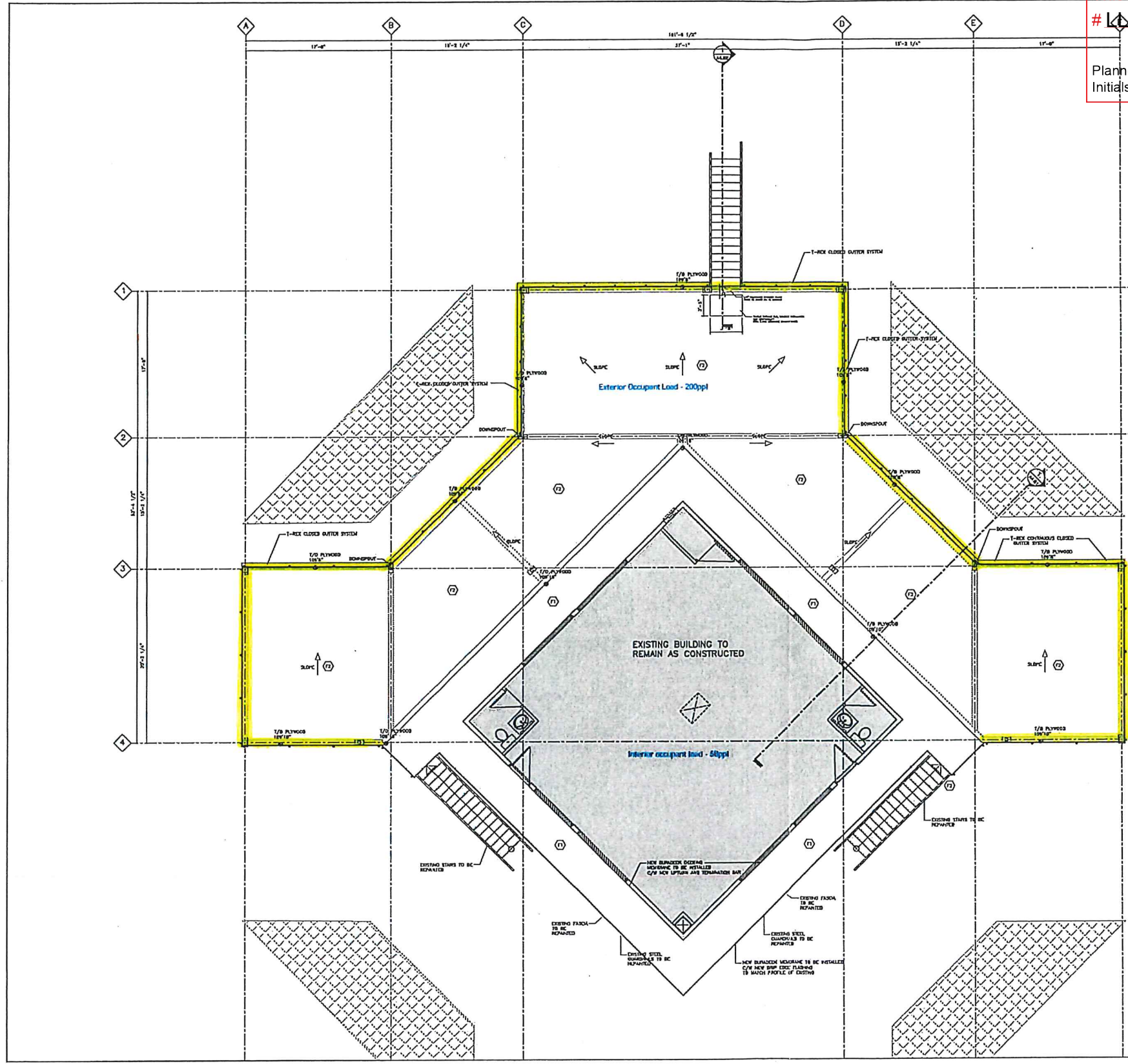

900 LEXINGTON DRIVE.

\* **KELOWNA KINSMEN**  
 The **SOFTBALL COMPLEX**  
 has a net floor area of  
N/A m<sup>2</sup>. The maximum  
 occupant load shall be  
600 persons.

AS PER PREVIOUS OCCUPANT LOAD  
 EXISTING NO CHANGE BCBC 1.1.1.2

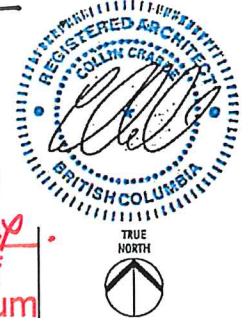

Copyright reserved. No plan and design and  
 all other contents are the exclusive property of  
 MEKLEJOHN ARCHITECTS INC. and may not be used  
 without the Architect's consent.

No.	Date	Revision
1	2017.01.20	ISSUED FOR BUILDING PERMIT
2	2017.07.21	PROCESSED FOR PERMIT
3	2017.12.08	RE-CHECK FOR TOWER
4	2018.11.07	ISSUED FOR CONSTRUCTION

**Reviewed**  
 by City of Kelowna  
 Inspection Services  
 MAY 20 2021

SCALE 3/16" = 1'-0"

Project Title  
**KELOWNA KINSMEN  
 SOFTBALL COMPLEX  
 MISSION SPORTFIELDS**

4105 GORDON DRIVE KELOWNA BC

Drawing Number  
**A3.02**

REVISIONS ARE NOT TO BE SCALED.  
 ALL DIMENSIONS SHALL BE VERIFIED ON JOB

Drawing Title  
**PROPOSED SECOND  
 FLOOR PLAN**

Drawn	Checked
AS SHOWN	20

## Addition of (permanent) Outdoor Patio at Kinsmen Softball Quadplex

900 Lexington Dr.

**Purpose** – the outdoor viewing patio project was a joint venture between City of Kelowna & Kelowna Adult Softball Association. It was designed to enhance the viewing experience for players and spectators, and create a social environment at the ballpark.

**Events** – Kinsmen Softball Quadplex is home to numerous slo-pitch leagues & tournaments in Kelowna

### **League Play**

- City of Kelowna Slo-Pitch League (one of the biggest slo-pitch leagues in Canada)
- Major Men's Slo-Pitch League (Kelowna Adult Softball Association)
- Ladies Slo-Pitch League (Kelowna Adult Softball Association)
- Major Mixed Slo-Pitch League
- Senior's Slo-Pitch League
- Kinsmen Slo-Pitch League



These organizations typically have games scheduled 2-3 times per week, evenings 6-11pm. A typical slo-pitch season is May 1-Sep 1, with the City of Kelowna league running longer (mid-Apr to end of Oct).

**Tournament Play** – with the exception of approx. 2-3 weekends during a season, there is a slo-pitch tournament or league playoffs every weekend from May 1-Sep 15.

-These tournaments are hosted by Kelowna based organizations and many of them attract teams from outside of Kelowna. During tournament play, Kinsmen Softball Quadplex (M1-M4) will host games from Friday 6pm thru to Sunday at 6pm on all 4 diamonds. Some of the larger tournaments also use M5-M6.

**Capacity** – during league play (evenings 6pm-11pm), you will have 8 teams of approx. 14 players/team participating at the Quadplex during any given timeslot. Game start times are typically: 6pm, 7:30pm, & 9pm. At any given time during league night play, there are no more than 200 persons on-site at any given time. For tournament play, there are more opportunities for teams to linger between games, so the estimated capacity would rise to 300 persons on-site at any given time. There are no other instances, maybe a one-time special event, where there would be more than 300 persons on-site at any given time during the ball season. There is a designated “beer garden” area with picnic tables between diamonds M1 & M2. Before the viewing deck patio was constructed, this is where many teams would congregate in a social manner in between or after games.

City of Kelowna is not looking to increase the capacity of the liquor license, we simply want to include the new outdoor viewing deck patio within the current site.

**Concession Operator** - Active Living & Culture email the concession operator (hired via third party agreement through Kelowna Adult Softball Association) a weekly report of scheduled activities at the Quadplex. Concession operator is expected to be Open for all hours of scheduled play. Overall, the Kinsmen Softball Quadplex is a low-key venue. Liquor service is sold out of the concession window as a service to players & spectators, and as a way for Kelowna Adult Softball Association to raise money for "the reserve" to be then used for park improvements. In fact, a considerable amount of funds were allocated from "the reserve" to pay for the new outdoor viewing patio.