

The occupant load shall be based on seating and have an occupant load of 105 persons.

REVIEWED BY CITY OF KELOWNA INSPECTIONS SERVICES

FORMING PART OF BUILDING PERMIT # \_\_\_\_\_ THESE DRAWINGS SHALL REMAIN ON SITE AVAILABLE TO CITY BUILDING INSPECTORS

DATE MAY 20/21 PLAN CHECKER L. Paly

**ATTACHMENT A**

This forms part of application # LL21-0004

Planner Initials **KB**



City of Kelowna  
DEVELOPMENT PLANNING

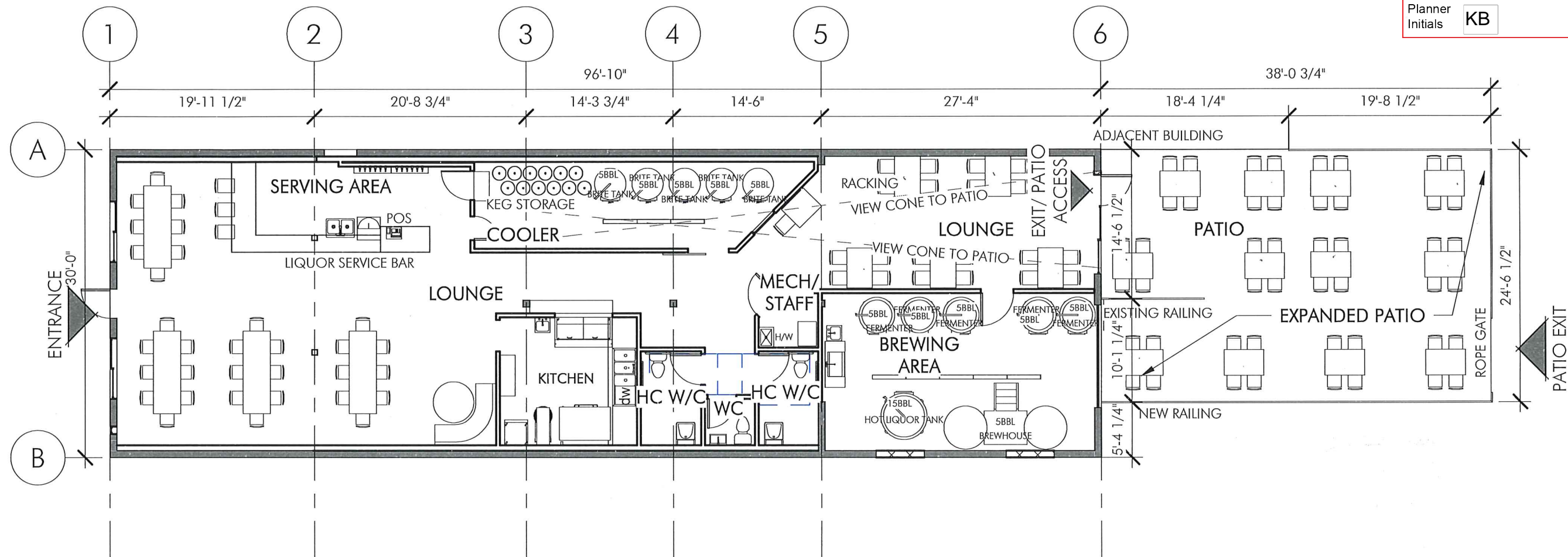

1 LL LEVEL 1 FLOOR PLAN  
LL01 SCALE - 3/32" = 1'-0"

Occupant Load: Based on 3.7.17.7 of the 2018 BCBC

Brewery Area	27.5 sqm @ 4.6 sqm/ person = 6 persons
Storage Area	34 sqm @ 46 sqm/ person = 1 persons
Tasting Area	71.8 sqm @ 1.2 sqm/ person = 60 persons
Patio	57.1 sqm @ 1.2 sqm/ person = 48 persons

TOTAL 115 persons

NOTE: 75% OF GFA USED FOR AREA CALCULATIONS SINCE ROUGHLY 25% OF THE SPACE WILL BE USED FOR CIRCULATION AND FURNITURE.

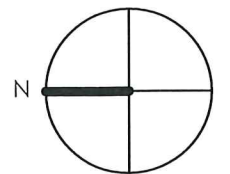
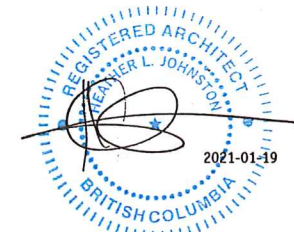

DRAWING:	LL PLANS
SCALE:	3/32" = 1'-0"

PROJECT NAME:	JACKKNIFE BREWERY 727 BAILLIE AVENUE KELOWNA, BC
---------------	--

NO	DATE	ISSUE
01	20190314	LL APPLICATION
02	20191030	REVISION
03	20210115	REVISION

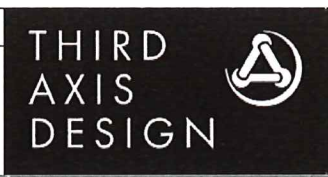

heather ljohnston architect AIBC  
PLACE architect ltd.  
6262 st georges avenue  
west vancouver bc, v7w 1z7  
778 386 6769  
www.placearchitects.com

