

CITY OF KELOWNA

BYLAW NO. 12145

TA20-0025 – Schedule 'B' Comprehensive Development Zones CD16 – Bingo and Gaming

A bylaw to amend the "City of Kelowna Zoning Bylaw No. 8000".

The Municipal Council of the City of Kelowna, in open meeting assembled, enacts as follows:

1. THAT **Section 18 – Schedule 'B' – Comprehensive Development Zones, CD16 – Bingo and Gaming, 1.4 Development Regulations** be amended by:

Deleting the following:

"(b) The maximum **site coverage** is 25%"

"(e) The minimum **side yard** is 15.0m"

"(f) The minimum **rear yard** is 21.0 m"

And replacing it with:

"(b) The maximum **site coverage** is 27.3%"

"(e) The minimum **side yard** is 14.39 m"

"(f) The minimum **rear yard** is 15.86 m"

2. AND THAT **Section 18 – Schedule 'B' – Comprehensive Development Zones, CD16 – Bingo and Gaming, 1.5(c) Other Regulations** be amended by:

Deleting the following:

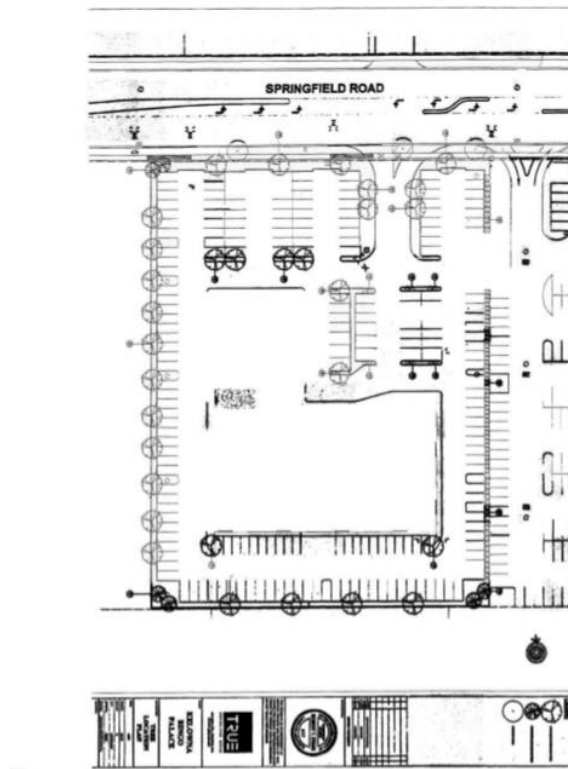

CD16 – Bingo and Gaming – Site Plan

LIME
LANDSCAPE ARCHITECTURE
INCORPORATED
2000 10th Avenue West, Suite 100
Kelowna, BC V1Y 9V6
Tel: 250-860-1111
Fax: 250-860-1112
www.lime.ca

NOTES:

1. ALL DIMENSIONS ARE IN METERS UNLESS OTHERWISE NOTED.
2. ALL DIMENSIONS ARE TO FACE UNLESS OTHERWISE NOTED.
3. ALL DIMENSIONS ARE TO CENTERLINE UNLESS OTHERWISE NOTED.
4. ALL DIMENSIONS ARE TO EXISTING UNLESS OTHERWISE NOTED.
5. ALL DIMENSIONS ARE TO PROPOSED UNLESS OTHERWISE NOTED.
6. ALL DIMENSIONS ARE TO EXISTING UNLESS OTHERWISE NOTED.
7. ALL DIMENSIONS ARE TO PROPOSED UNLESS OTHERWISE NOTED.
8. ALL DIMENSIONS ARE TO EXISTING UNLESS OTHERWISE NOTED.
9. ALL DIMENSIONS ARE TO PROPOSED UNLESS OTHERWISE NOTED.
10. ALL DIMENSIONS ARE TO EXISTING UNLESS OTHERWISE NOTED.

CHANCES CASINO
1585 SPRINGFIELD RD, KELOWNA BC
V1Y 9V6
TEL: 250-860-1111
FAX: 250-860-1112
WWW.CHANCESCASINO.COM

CHANCES CASINO
1585 SPRINGFIELD RD, KELOWNA BC
V1Y 9V6
TEL: 250-860-1111
FAX: 250-860-1112
WWW.CHANCESCASINO.COM

CHANCES CASINO
1585 SPRINGFIELD RD, KELOWNA BC
V1Y 9V6
TEL: 250-860-1111
FAX: 250-860-1112
WWW.CHANCESCASINO.COM

CHANCES CASINO
1585 SPRINGFIELD RD, KELOWNA BC
V1Y 9V6
TEL: 250-860-1111
FAX: 250-860-1112
WWW.CHANCESCASINO.COM

CHANCES CASINO - NEW ADDITIONS

1585 SPRINGFIELD RD, KELOWNA, BC

ZONING CALCULATIONS:
CURRENT: CITY OF KELOWNA, CD-18 (COMPREHENSIVE DEVELOPMENT - INDOOR AND GAMING)

SITE INFORMATION:

PROPOSED	EXISTING
CHANCES CASINO	CHANCES CASINO
1585 SPRINGFIELD RD	1585 SPRINGFIELD RD
KELOWNA, BC	KELOWNA, BC
V1Y 9V6	V1Y 9V6
TEL: 250-860-1111	TEL: 250-860-1111
FAX: 250-860-1112	FAX: 250-860-1112
WWW.CHANCESCASINO.COM	WWW.CHANCESCASINO.COM

CHANCES CASINO

PROPOSED	EXISTING
CHANCES CASINO	CHANCES CASINO
1585 SPRINGFIELD RD	1585 SPRINGFIELD RD
KELOWNA, BC	KELOWNA, BC
V1Y 9V6	V1Y 9V6
TEL: 250-860-1111	TEL: 250-860-1111
FAX: 250-860-1112	FAX: 250-860-1112
WWW.CHANCESCASINO.COM	WWW.CHANCESCASINO.COM

CHANCES CASINO

PROPOSED	EXISTING
CHANCES CASINO	CHANCES CASINO
1585 SPRINGFIELD RD	1585 SPRINGFIELD RD
KELOWNA, BC	KELOWNA, BC
V1Y 9V6	V1Y 9V6
TEL: 250-860-1111	TEL: 250-860-1111
FAX: 250-860-1112	FAX: 250-860-1112
WWW.CHANCESCASINO.COM	WWW.CHANCESCASINO.COM

ATTACHMENT A

This forms part of application
TA20-0025

City of Kelowna
DEVELOPMENT PLANNING

Planner Initials **TC**

PROPERTY DESCRIPTION:
CHANCES CASINO
1585 SPRINGFIELD RD, KELOWNA BC
V1Y 9V6
TEL: 250-860-1111
FAX: 250-860-1112
WWW.CHANCESCASINO.COM

CASINO FLOOR AREAS

PROPOSED	EXISTING
CHANCES CASINO	CHANCES CASINO
1585 SPRINGFIELD RD	1585 SPRINGFIELD RD
KELOWNA, BC	KELOWNA, BC
V1Y 9V6	V1Y 9V6
TEL: 250-860-1111	TEL: 250-860-1111
FAX: 250-860-1112	FAX: 250-860-1112
WWW.CHANCESCASINO.COM	WWW.CHANCESCASINO.COM

CHANCES CASINO

PROPOSED	EXISTING
CHANCES CASINO	CHANCES CASINO
1585 SPRINGFIELD RD	1585 SPRINGFIELD RD
KELOWNA, BC	KELOWNA, BC
V1Y 9V6	V1Y 9V6
TEL: 250-860-1111	TEL: 250-860-1111
FAX: 250-860-1112	FAX: 250-860-1112
WWW.CHANCESCASINO.COM	WWW.CHANCESCASINO.COM

CHANCES CASINO

PROPOSED	EXISTING
CHANCES CASINO	CHANCES CASINO
1585 SPRINGFIELD RD	1585 SPRINGFIELD RD
KELOWNA, BC	KELOWNA, BC
V1Y 9V6	V1Y 9V6
TEL: 250-860-1111	TEL: 250-860-1111
FAX: 250-860-1112	FAX: 250-860-1112
WWW.CHANCESCASINO.COM	WWW.CHANCESCASINO.COM

CHANCES CASINO

PROPOSED	EXISTING
CHANCES CASINO	CHANCES CASINO
1585 SPRINGFIELD RD	1585 SPRINGFIELD RD
KELOWNA, BC	KELOWNA, BC
V1Y 9V6	V1Y 9V6
TEL: 250-860-1111	TEL: 250-860-1111
FAX: 250-860-1112	FAX: 250-860-1112
WWW.CHANCESCASINO.COM	WWW.CHANCESCASINO.COM

CHANCES CASINO
1585 SPRINGFIELD RD, KELOWNA BC
V1Y 9V6
TEL: 250-860-1111
FAX: 250-860-1112
WWW.CHANCESCASINO.COM

CHANCES CASINO
1585 SPRINGFIELD RD, KELOWNA BC
V1Y 9V6
TEL: 250-860-1111
FAX: 250-860-1112
WWW.CHANCESCASINO.COM

CHANCES CASINO
1585 SPRINGFIELD RD, KELOWNA BC
V1Y 9V6
TEL: 250-860-1111
FAX: 250-860-1112
WWW.CHANCESCASINO.COM

CHANCES CASINO
1585 SPRINGFIELD RD, KELOWNA BC
V1Y 9V6
TEL: 250-860-1111
FAX: 250-860-1112
WWW.CHANCESCASINO.COM

CHANCES CASINO
1585 SPRINGFIELD RD, KELOWNA BC
V1Y 9V6
TEL: 250-860-1111
FAX:

3. AND FURTHER THAT **Section 18 – Schedule 'B' – Comprehensive Development Zones, CD16 – Bingo and Gaming, 1.5(e) Other Regulations** be amended by adding the following:

The minimum drive aisle for a double lane drive aisle is 6.1m;

4. This bylaw shall come into full force and effect and is binding on all persons as and from the date of adoption.

Read a first time by the Municipal Council this 18th day of January, 2021.

Considered at a Public Hearing on the

Read a second and third time by the Municipal Council this

Approved under the Transportation Act this

(Approving Officer-Ministry of Transportation)

Adopted by the Municipal Council of the City of Kelowna this

Mayor

City Clerk