



Z20-0054 1508 Pinehurst Cr

Rezoning Application



Proposal

- ▶ To rezone the subject property from RU₁ – Large Lot Housing to RU_{1C} – Large Lot Housing with Carriage House.

Development Process

Jul 13, 2020

Development Application Submitted



Staff Review & Circulation



Aug 8, 2020

Public Notification Received



Oct 5, 2020

Initial Consideration



Public Hearing
Second & Third Readings



Final Reading
DP & Variances



Building Permit

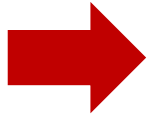

Council
Approvals

Context Map



Subject Property Map



Project details

- ▶ The detached garage was built in 1963, the same year as the principal dwelling.
- ▶ The garage would be converted into a carriage house and it would be 45m² (484ft²) in size.
- ▶ The proposed carriage house will meet all Zoning Bylaw Regulations.

Site Photos



Site Plan

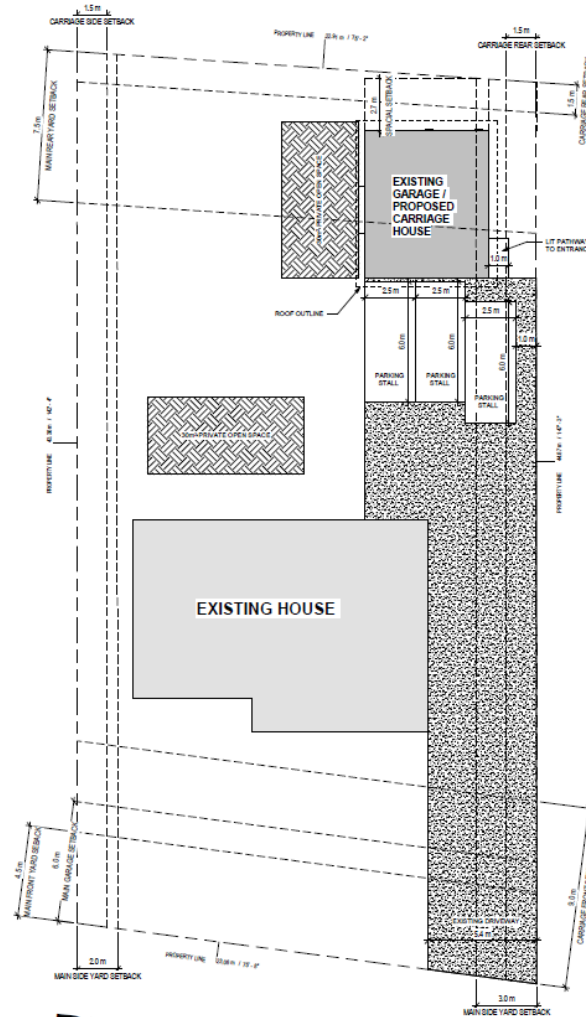

PINEHURST CRT.

Staff Recommendation

- ▶ Development Planning Staff recommend **support** of the proposed Rezoning:
 - ▶ Subject property is within the Permanent Growth Boundary.
 - ▶ Aligns with the Official Community Plan and Future Land Use of S2RES.



Conclusion of Staff Remarks