

SCHEDULE

A

This forms part of application

Z20-0017

Planner
Initials

TC



CITY OF KELOWNA

MEMORANDUM

Date: February 25, 2020
File No.: Z20-0017
To: Suburban and Rural Planning (TC)
From: Development Engineering Manager (JK)
Subject: 4633 Frederick Rd. RU1 to RU2

The Development Engineering Department has the following comments and requirements associated with this application to rezone the subject property from RU1 to RU6. The road and utility upgrading requirements outlined in this report will be a requirement of this development. The Development Engineering Technician for this project is Aaron Sangster.

1. Domestic Water and Fire Protection

- a) The subject property is currently serviced with a 19mm water service. One metered water service will be required for the development. The disconnection of the existing small diameter water services and the tie-in of a larger service is the developer's responsibility. You can engage an engineer and contractor to manage the work on your behalf or it can be provided by City forces at the developer's expense. If you chose to have it completed by City forces, you will be required to sign a Third-Party Work Order and pre-pay for the cost of the water service upgrades. For estimate inquiries please contact Mike Thomas, by email mthomas@kelowna.ca or phone, 250-469-8797.

2. Sanitary Sewer

- a) This property is currently serviced with a 100-mm sanitary service. The developer's consulting mechanical engineer will determine the development requirements of this proposed development and establish the service needs. Only one service will be permitted for this development. The applicant, at their cost, will arrange for the removal and disconnection of the existing services and the installation of one new larger service, if necessary.

3. Storm Drainage

- a) The developer must engage a consulting civil engineer to provide a storm water management plan for the site, which meets the requirements of the Subdivision, Development and Servicing Bylaw No. 7900. The storm water management plan must also include provision of lot grading plan, minimum basement elevation (MBE), if applicable, and provision of a storm drainage service for the development and / or recommendations for onsite drainage containment and disposal systems. Only one service will be permitted for this development. The applicant, at his cost, will arrange the installation of one overflow service if required.

4. Electric Power and Telecommunication Services

- a) All proposed service connections are to be installed underground. It is the



developer's responsibility to make a servicing application with the respective electric power, telephone and cable transmission companies to arrange for these services, which would be at the applicant's cost.

5. **Road Improvements**

- a) Frederick Rd. must be upgraded to a local standard along the full frontage of this proposed development, curb and gutter, drainage system, catch basin, manholes, irrigated landscaped boulevard, pavement removal and replacement, and re-location or adjustment of utility appurtenances if required to accommodate the upgrading construction. The road cross section to be used is a SS-R3.
- b) Hubbard Rd. must be upgraded to a local standard along the full frontage of this proposed development, curb and gutter, drainage system, catch basin, manholes, irrigated landscaped boulevard, pavement removal and replacement, and re-location or adjustment of utility appurtenances if required to accommodate the upgrading construction. The road cross section to be used is a SS-R3.

6. **Erosion Servicing Control Plan**

- a) Provide a detailed ESC Plan for this development as per the Subdivision, Development and Servicing Bylaw #7900.
- b) The developer must engage a consulting civil engineer to provide an ESC plan for this site which meets the requirements of the City Subdivision Development and Servicing Bylaw 7900.
- c) Civil consultant is responsible for all inspection and maintenance.
- d) A Security Deposit for ESC Works equal to 3.0% of the Consulting Engineer's opinion of probable costs of civil earthworks and infrastructure will be added to the Servicing Agreement.

7. **Road Dedication and Subdivision Requirements**

- a) Grant Statutory Rights of Way if required for utility services.
- b) If any road dedication or closure affects lands encumbered by a Utility right-of-way (such as Hydro, Telus, Gas, etc.) please obtain the approval of the utility. Any works required by the utility as a consequence of the road dedication or closure must be incorporated in the construction drawings submitted to the City's Development Manager.

8. **Geotechnical Report**

Provide a geotechnical report prepared by a Professional Engineer competent in the field of hydro-geotechnical engineering to address the items below: NOTE: The City is relying on the Geotechnical Engineer's report to prevent any damage to property and/or injury to persons from occurring as a result of problems with soil slippage or soil instability related to this proposed subdivision. The Geotechnical reports must be submitted to the Development Services Department (Subdivision Approving officer) for distribution to the Development Engineering Branch and Inspection Services Division prior to submission of Engineering drawings or application for subdivision approval.

- (i) Area ground water characteristics, including any springs and overland surface drainage courses traversing the property. Identify any monitoring required.

SCHEDULE		A
This forms part of application # Z20-0017		
Planner Initials	TC	 City of Kelowna <small>DEVELOPMENT PLANNING</small>

- (ii) Site suitability for development.
- (iii) Site soil characteristics (i.e. fill areas, sulphate content, unsuitable soils such as organic material, etc.).
- (iv) Any special requirements for construction of roads, utilities and building structures.
- (v) Recommendations for items that should be included in a Restrictive Covenant.
- (vi) Recommendations for roof drains, perimeter drains and septic tank effluent on the site.
- (vii) Any items required in other sections of this document.

9. **Design and Construction**

- (a) Design, construction supervision and inspection of all off-site civil works and site servicing must be performed by a Consulting Civil Engineer and all such work is subject to the approval of the City Engineer. Drawings must conform to City standards and requirements.
- (b) Engineering drawing submissions are to be in accordance with the City's "Engineering Drawing Submission Requirements" Policy. Please note the number of sets and drawings required for submissions.
- (c) Quality Control and Assurance Plans must be provided in accordance with the Subdivision, Development & Servicing Bylaw No. 7900 (refer to Part 5 and Schedule 3).
- (d) A "Consulting Engineering Confirmation Letter" (City document 'C') must be completed prior to submission of any designs.
- (e) Before any construction related to the requirements of this subdivision application commences, design drawings prepared by a professional engineer must be submitted to the City's Works & Utilities Department. The design drawings must first be "Issued for Construction" by the City Engineer. On examination of design drawings, it may be determined that rights-of-way are required for current or future needs.

12. **Charges and Fees**

- a) Development Cost Charges (DCC's) are payable.
- b) Fees per the "Development Application Fees Bylaw" include:
 - i) Survey Monument, Replacement Fee: \$1,200.00 (GST exempt) – only if disturbed.
 - ii) Engineering and Inspection Fee: 3.5% of construction value (plus GST).



James Kay, P.Eng.
Development Engineering Manager
AS

This forms part of application

Z20-0017

Planner
Initials TC

City of
Kelowna
DEVELOPMENT PLANNING

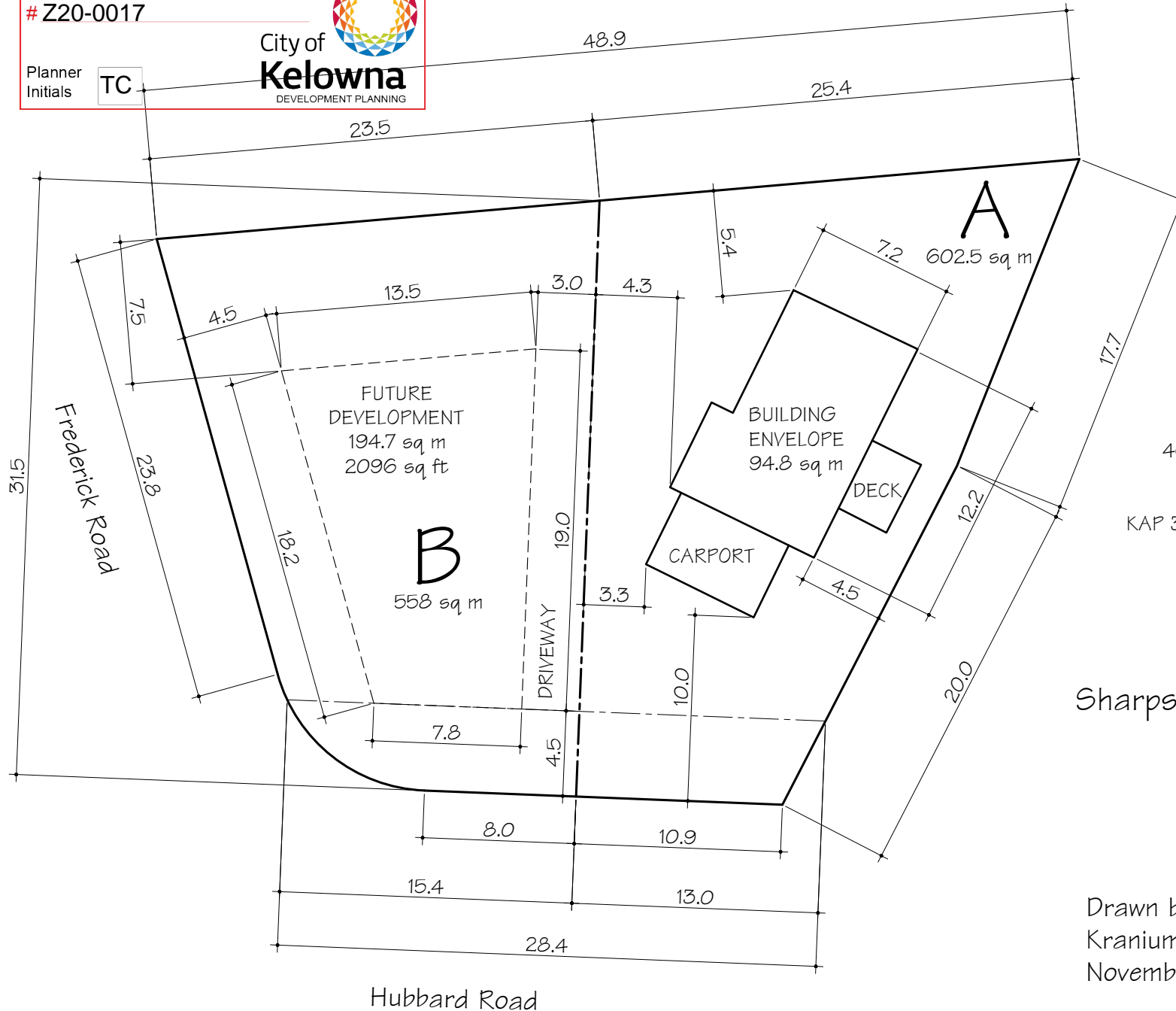

4633 Frederick Road
Kelowna BC
KAP 38083 LOT A DL 508A

Plot Plan
for
Sharpshooter Development
Company

Scale: 1:300

Drawn by R. Kroeker
Kranium Smart Design
November 20, 2019