

KIRSCHNER ROAD

OVERALL SITE PLAN
SCALE: 1" = 20'-0"
1851 KIRSCHNER, KELOWNA B.C.,
LOT 1, DL129, ODD, PLAN EPP18842



ATTACHMENT **A**

This forms part of application
LL18-0034

Planner
Initials **LK**

City of
Kelowna
COMMUNITY PLANNING

Notes:
© Copyright Reserved. This drawing and design are, and at all times remain, the property of Patrick McCusker Architecture Inc. and can be reproduced only in the written consent.
All drawings shall be read in conjunction with specifications and consultant details.
All work shall be carried out in accordance with Canadian standards, specifications, B.C. or A.B. Building Codes (Current Edition) and local authority by-laws and regulations.
Tabulated scales refer to Arch D size drawing sheet.
This drawing must not be scaled.
Contractors shall verify all dimensions prior to commencement of work.
Any omissions or discrepancies shall be reported to the architect.

Seal

- This document is:
- ☐ NOT controlled. Revisions may be made without notice.
 - ☒ A CONTROLLED document. Revisions will be advised.
 - ☐ The first issue of the document.
 - ☐ A complete revision. Remove previous issues from use.
 - ☐ A partial revision. Remove previous issues of corresponding sheets / pages from use.
 - ☒ For Construction Purposes



01 2018-12-03 PERMIT
No. Date Description
Revisions



PATRICK McCUSKER
ARCHITECTURE INC.
AAA MAIBC MRAIC
3430 BENVOLIN ROAD
KELOWNA BC V1W 4M5
Phone: 778-484-0223
pat@pmcarch.com
www.pmcarch.com

project title
COPPER BREWING CO.
BREWERY / TAPROOM
#102 - 1851 KIRSCHNER RD.
KELOWNA, B.C.

project no. 3383

file no.

drawing title
KEY PLAN

designed	SW	scale	AS SHOWN
drawn	SW		
checked	PM		
drawing no.			

A0

SIGNAGE ELEVATION 1
A 7

Reviewed
by City of Kelowna
Inspection Services

4x4 POSTS @ 48" o/c

ROUGH SAWN 1x6 PLANKING

EXISTING CONCRETE

3'-6"

1'-0"

PATIO RAIL SECTION

SCALE: 1" = 1'-0"

2
A 7

4x4 POSTS @ 48" c/c

ROUGH SAWN 1x6 PLANKING

EXISTING CONCRETE

4'-0" c/c

1'-0" c/c

1'-0" c/c

PATIO RAIL ELEVATION 3

SCALE: 1" = 1'-0"

A 7

The Ratio has a net floor area of 57 m². The maximum occupant load shall be 40 persons, based on Posted Occupancy

The Liquor Service Area,
has a net floor area of
98 m². The maximum
occupant load shall be
70 persons, based on
Posted Occupancy

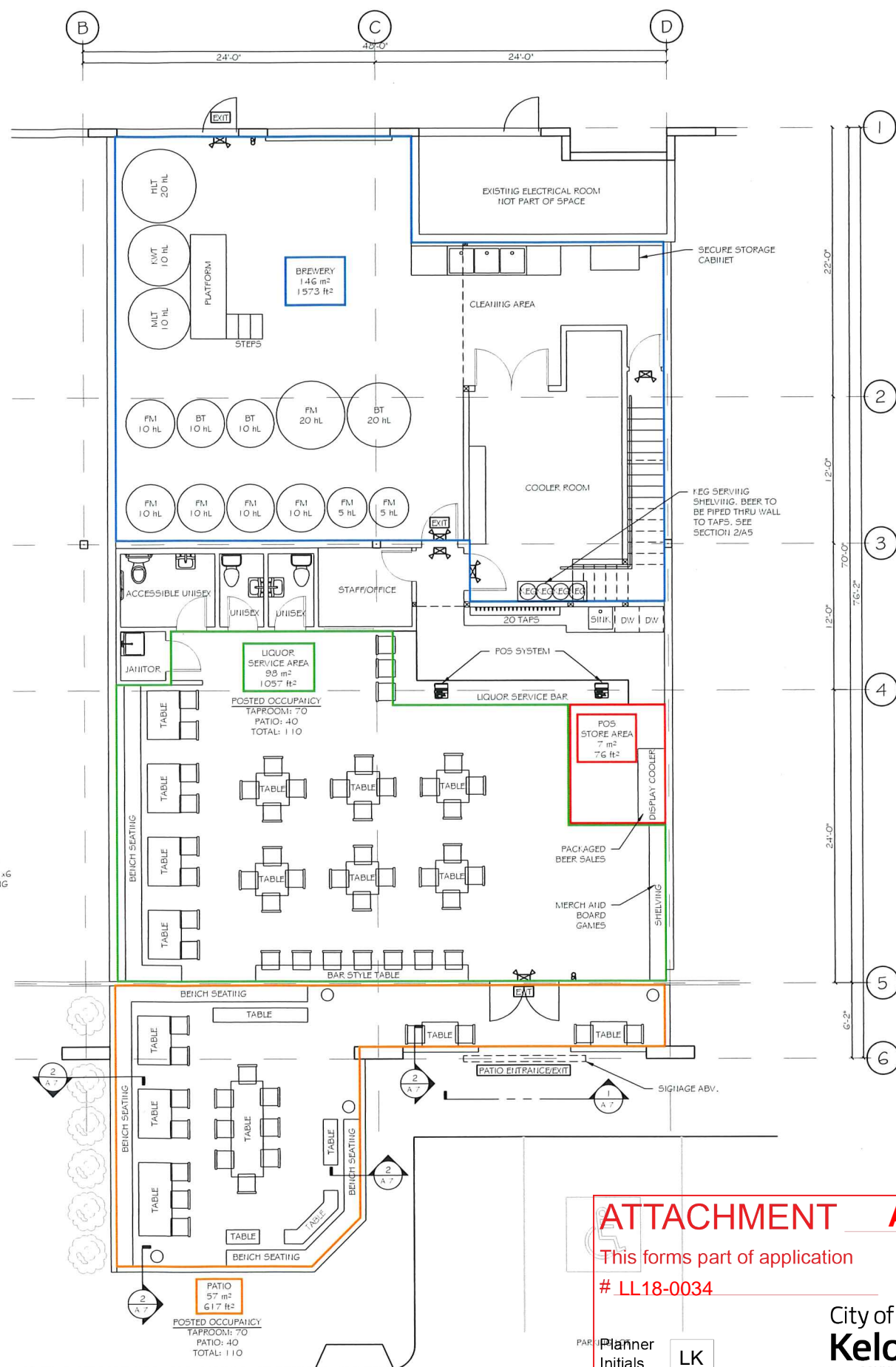

ATTACHMENT A

This forms part of application

LL18-0034

Planner Initials LK



City of Kelowna
COMMUNITY PLANNING

Notes:

© Copyright Reserved. This drawing and design are, and at all times remain, the property of Patrick McCusker Architecture Inc. and can be reproduced only with written consent.

All drawings shall be read in conjunction with specifications and consultant details.

All work shall be carried out in accordance with Canadian standards, specifications, B.C. or A.B. Building Codes (Current Edition) and local authority by-laws and regulations.

Tabulated scales refer to Arch D size drawing sheet.

This drawing must not be scaled.

Contractors shall verify all dimensions prior to commencement of work.

Any omissions or discrepancies shall be reported to the architect.

Seal

This document is:

☐ NOT controlled. Revisions may be made without notice.

☒ CD A CONTROLLED document. Revisions will be advised.

☐ The first issue of the document.

☐ A complete revision. Remove previous issues from use.

☐ A partial revision. Remove previous issues of corresponding sheets / pages from use.

☒ IFC For Construction Purposes

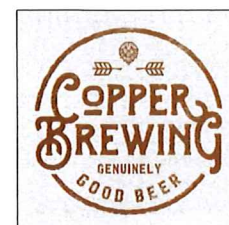

01	2018-12-03	PERMIT
No.	Date	Description
Revisions		

Revisions:

Revisions

Revisions:



PATRICK McCUSKER
ARCHITECTURE INC.

AAA MAIBC MRAIC
3430 BENOUILIN ROAD
KELOWNA BC V1W 4M5
~ Phone: 778-484-0223 ~
pat@pmccarch.com
www.pmccarch.com

project title
COPPER BREWING CO.
BREWERY / TAPROOM
#102 - 1851 KIRSCHNER RD.
KELOWNA, B.C.

project no. 3383

file no.

drawing title

**LIQUOR SERVICE
PLAN**

designed	SW	scale	AS SHOWN
drawn	SW		
checked	PM		
drawing no.			

A7