

# SCHEDULE A – Site Plan

Subject: 165 Venus Rd (Application Z19-0120)

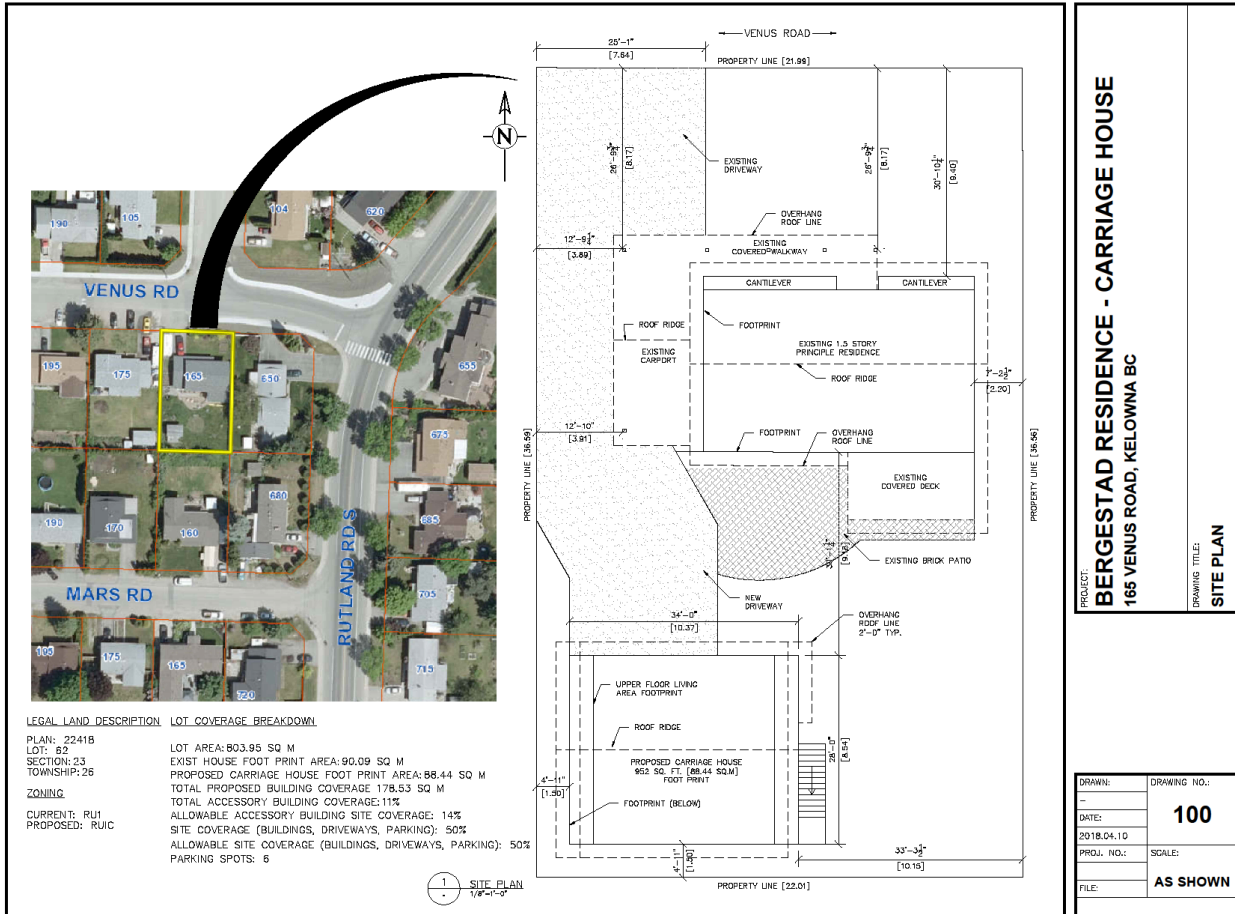

PROJECT: **BERGESTAD RESIDENCE - CARRIAGE HOUSE**  
 165 VENUS ROAD, KELOWNA BC

DRAWING TITLE: **SITE PLAN**

DRAWN:	DRAWING NO.:
DATE:	<b>100</b>
PROJ. NO.:	SCALE:
FILE:	<b>AS SHOWN</b>

# SCHEDULE B – Development Engineering Memo



**Subject:** 165 Venus Rd (Application Z19-0120)

---

**CITY OF KELOWNA  
MEMORANDUM**

---

**Date:** December 14, 2018  
**File No.:** DVP18-0244  
**To:** Urban Planning Management (LC)  
**From:** Development Engineering Manager (JK)  
**Subject:** 165 Venus Rd.

---

Development Engineering comments and requirements regarding this development permit application are as follows:

This development variance permit application to vary the maximum carriage house footprint size from 90m<sup>2</sup> to 114.5m<sup>2</sup>, does not compromise any municipal services.

  
James Kay, P.Eng.  
Development Engineering Manager

agm

---