

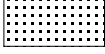

**Subject Properties Notes:**  
 Amend a portion of the subject property from S2RESH - Single /Two Unit Residential - Hillside to PARK - Major Park and Open Space

**Subject Properties Notes:**  
 Amend a portion of the subject property from PARK - Major Park and Open Space to S2RESH - Single/Two Unit Residential - Hillside

**Subject Properties Notes:**  
 Amend a portion of the subject property from MRC - Multiple Unit Residential (Cluster Housing) to S2RESH - Single/Two Unit Residential - Hillside

**MAP "A" OCP AMENDMENT  
 File OCP18-0009**

-  Subject Property
-  MRC to S2RESH
-  PARK to S2RESH
-  S2RESH to PARK



This map is for general information only. The City of Kelowna does not guarantee its accuracy. All information should be verified.



Rev. Wednesday, August 08, 2018

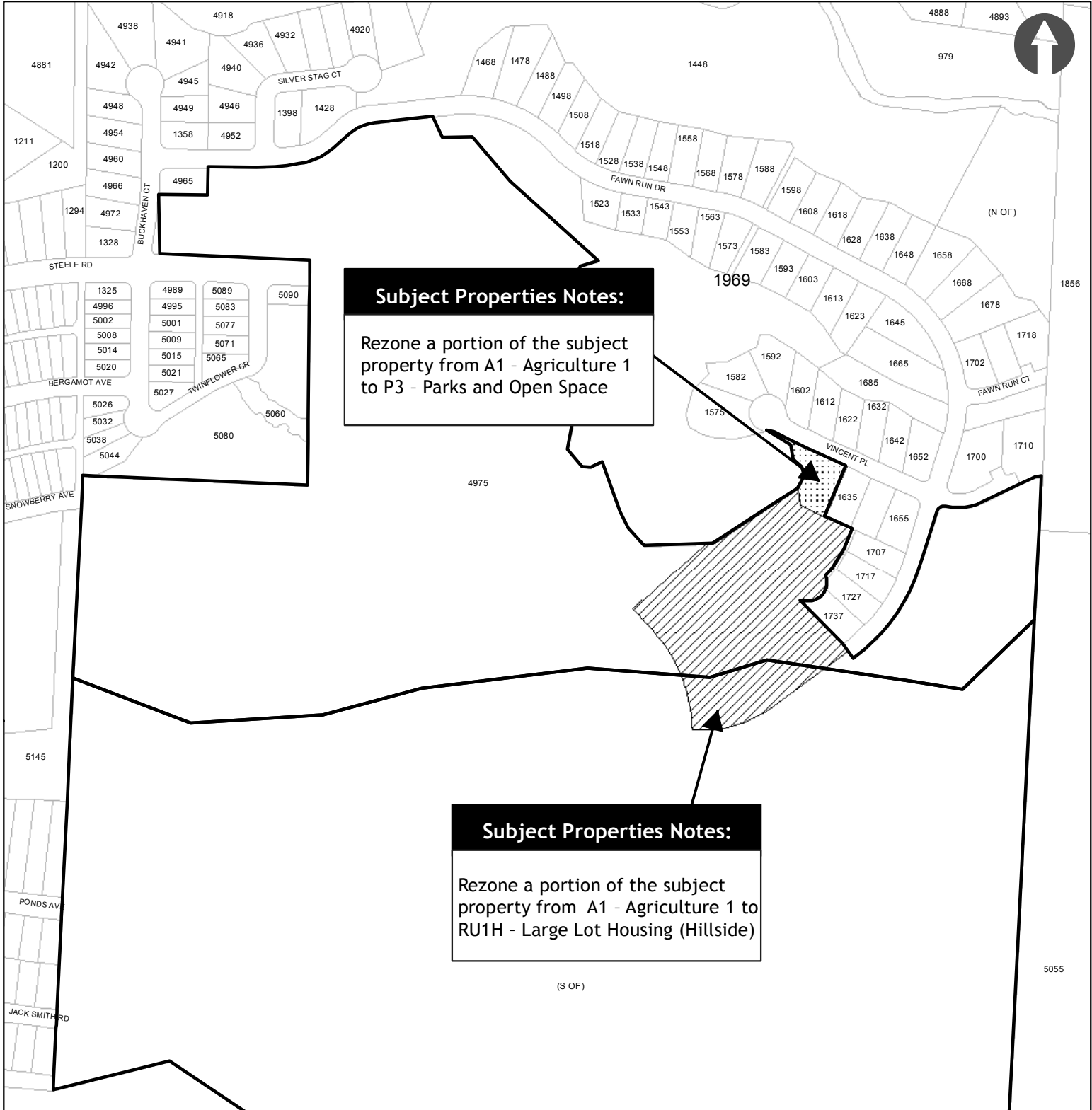



**Subject Properties Notes:**

Rezone a portion of the subject property from A1 - Agriculture 1 to P3 - Parks and Open Space

**Subject Properties Notes:**

Rezone a portion of the subject property from A1 - Agriculture 1 to RU1H - Large Lot Housing (Hillside)

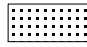
**MAP "B" PROPOSED ZONING**  
File Z18-0043

-  Subject Property
-  A1 to P3
-  A1 to RU1H

This map is for general information only. The City of Kelowna does not guarantee its accuracy. All information should be verified.



**NEIGHBOURHOOD 3  
AREA STRUCTURE PLAN**

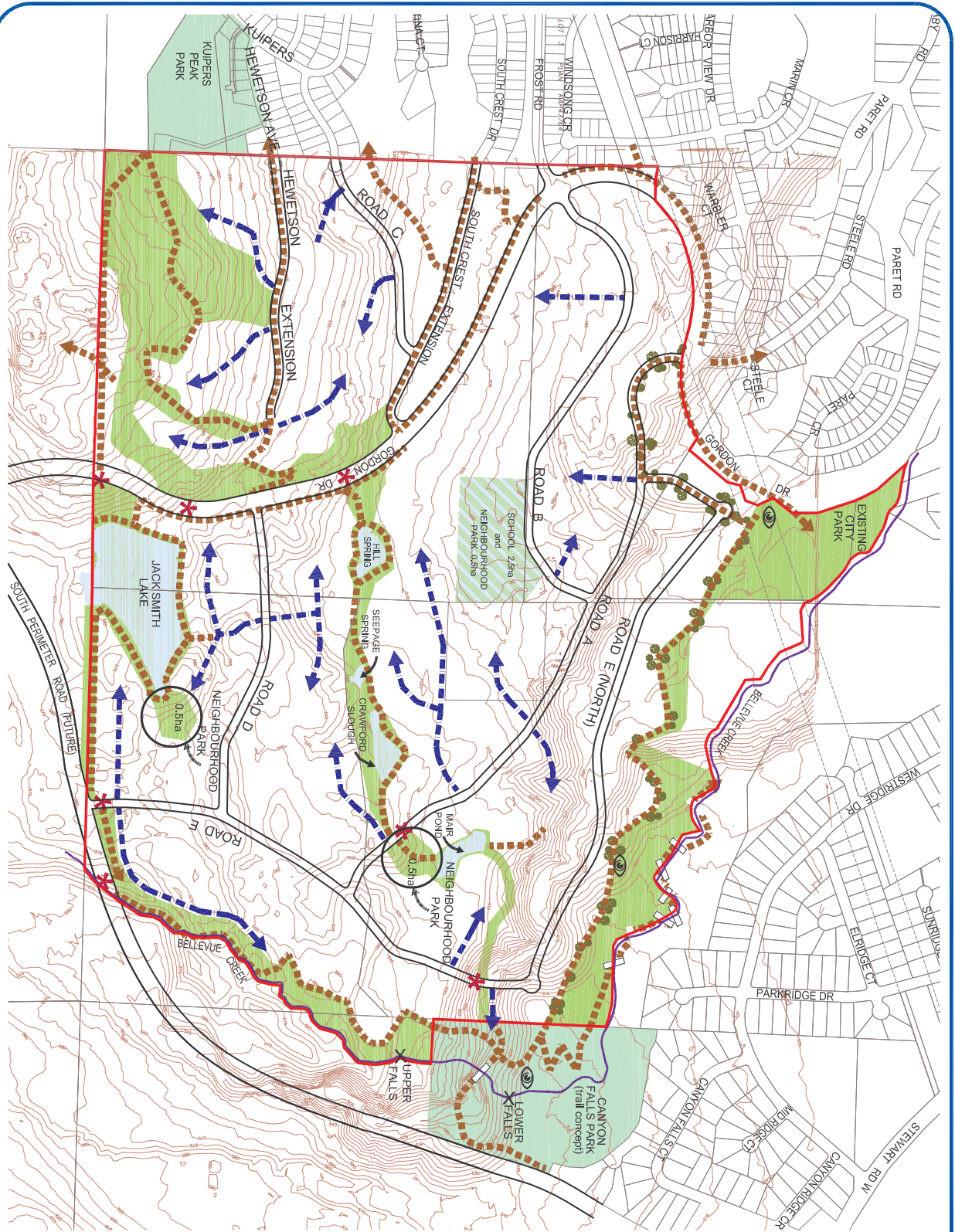

SCALE: 1:7500



**LEGEND**

- SCHOOL
- MAJOR PARK/GREEN SPACE (grade or priority)
- WATER FEATURE
- MAJOR ROADS
- POTENTIAL ROAD ACCESS
- KEY PEDESTRIAN ROUTE
- RECREATION CORRIDOR
- PEDESTRIAN BRIDGE
- PLAN AREA BOUNDARY
- WILDLIFE CROSSINGS
- VIEW POINTS

**MAP 10 - PARKS AND PATHWAY PLAN**  
 CONTOURS: 5m  
 DATE: FEBRUARY 6, 2007





**NEIGHBOURHOOD 3  
AREA STRUCTURE PLAN**

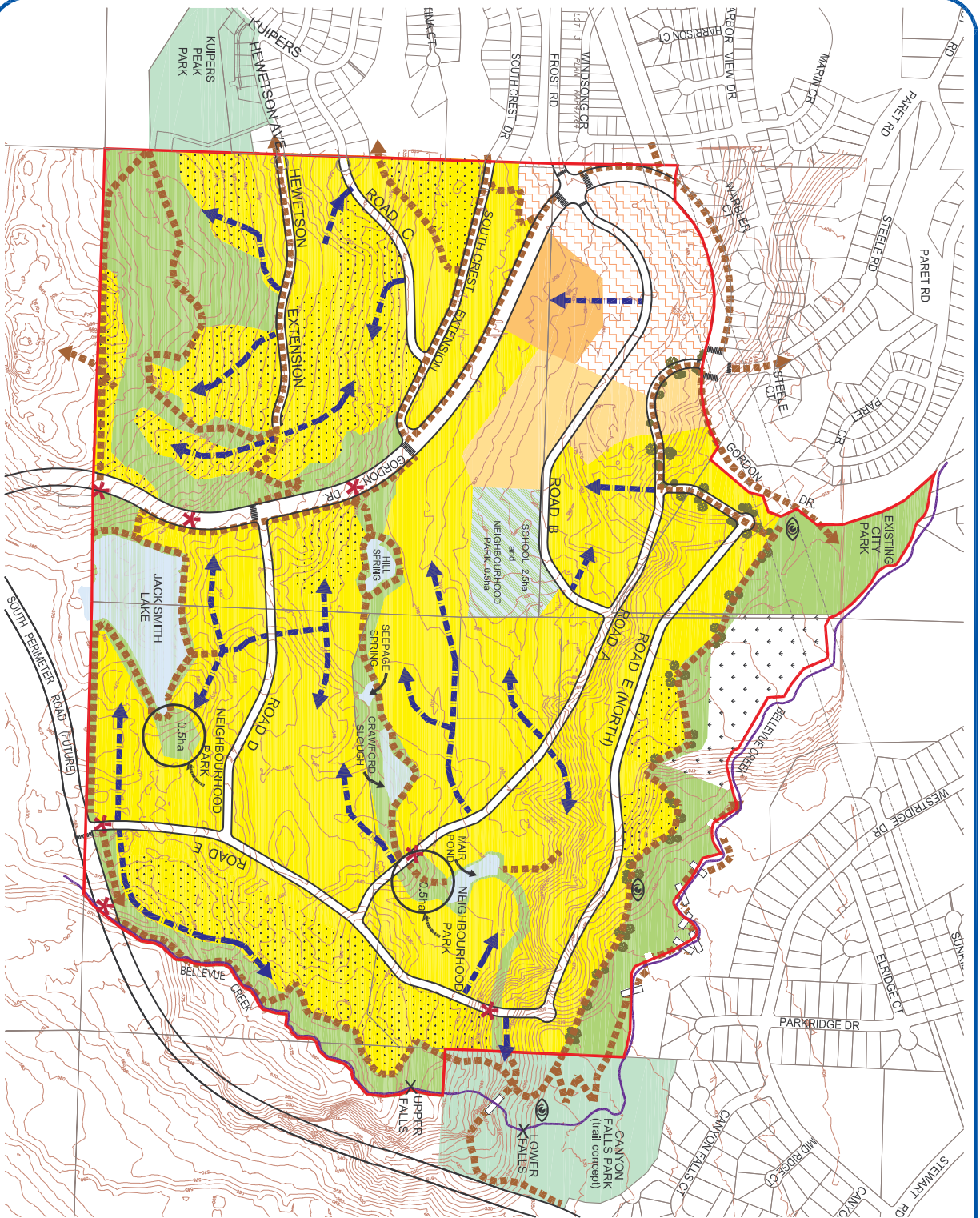

**LEGEND**

Symbol/Color	Description	HA	% OF TOTAL
[Dotted pattern]	RURAL/AGRICULTURE	3.8	2
[Yellow pattern]	SINGLE/TWO UNIT RES.	75.0	42
[Light yellow pattern]	CLUSTER	20.8	17
[Orange pattern]	LOW DENSITY	5.5	4
[Dark orange pattern]	MULTI UNIT RES.	2.5	1
[Red pattern]	MED. DENSITY	7.2	4
[Green pattern]	COMMERCIAL / MIXED USE	2.5	1
[Blue pattern]	SCHOOL	2.5	1
[Light green pattern]	MAJOR PARK/OPEN SPACE (public or private)	33.7	19
[Blue wavy lines]	WATER FEATURE	4.3	3
[Blue lines]	MAJOR ROADS	13.1	8
[Total]	TOTAL	177.4	100

[Blue dashed line]	POTENTIAL ROAD ACCESS
[Blue dashed line with arrow]	KEY PEDESTRIAN ROUTE
[Green dashed line]	RECREATION CORRIDOR
[Green dashed line with bridge]	PEDESTRIAN BRIDGE
[Green dashed line with cross]	CROSS WALKS
[Red dashed line]	PLAN AREA BOUNDARY
[Red dashed line with cross]	WILDLIFE CROSSING
[Eye icon]	VIEW POINTS

**MAP 8-DEVELOPMENT CONCEPT**  
 CONTOURS: 5m  
 DATE: FEBRUARY 6, 2007

