



THESE DRAWINGS ARE THE EXCLUSIVE PROPERTY OF IHS
DESIGN AND MAY NOT BE REPRODUCED OR USED WITHOUT
EXPRESSED WRITTEN PERMISSION FROM THE SAME.



REVISION	DATE	DISCRPTION

PROJECT

RU6 DEVELOPMENT

2005 LINDAHL STREET

KELOWNA, BC V1Y 3Z7

LOT 4 PLAN KAP19208

DRAWING TITLE

SITE PLAN

DATE MARCH 15, 2018

DRAWING NUMBER

1
— of —
1

PROJECT DATA: CIVIC ADDRESS		2005 LINDAHL STREET KELOWNA, BC V1Y 3Z7
LEGAL ADDRESS		LOT 4 PLAN KAP19208
CURRENT ZONING		RU2 MEDIUM LOT HOUSING
	PERMITTED	PROPOSED
SITE AREA	700.00m ²	1395.46m ²
EXISTING DWELLING FOOTPRINT AT GRADE		164.56m ²
EXISTING DWELLING COVERED PATIO		19.51m ²
PROPOSED DWELLING FOOTPRINT AT GRADE		118.92m ²
PROPOSED DRIVEWAY & WALKWAY AREA		143.70m ²
SITE COVERAGE	40.0%	21.7%
SITE COVERAGE W/ DRIVEWAY	50.0%	32.0%
DISTANCE BETWEEN BUILDINGS	4.500m	5.904m
FRONT (WEST) YARD SETBACK (GARAGE TO P.L.)	6.000m	23.043m
REAR (EAST) YARD SETBACK	4.500m	4.500m
SIDE (NORTH) YARD SETBACK	2.300m	27.753m
SIDE (SOUTH) YARD SETBACK	2.300m	2.352m

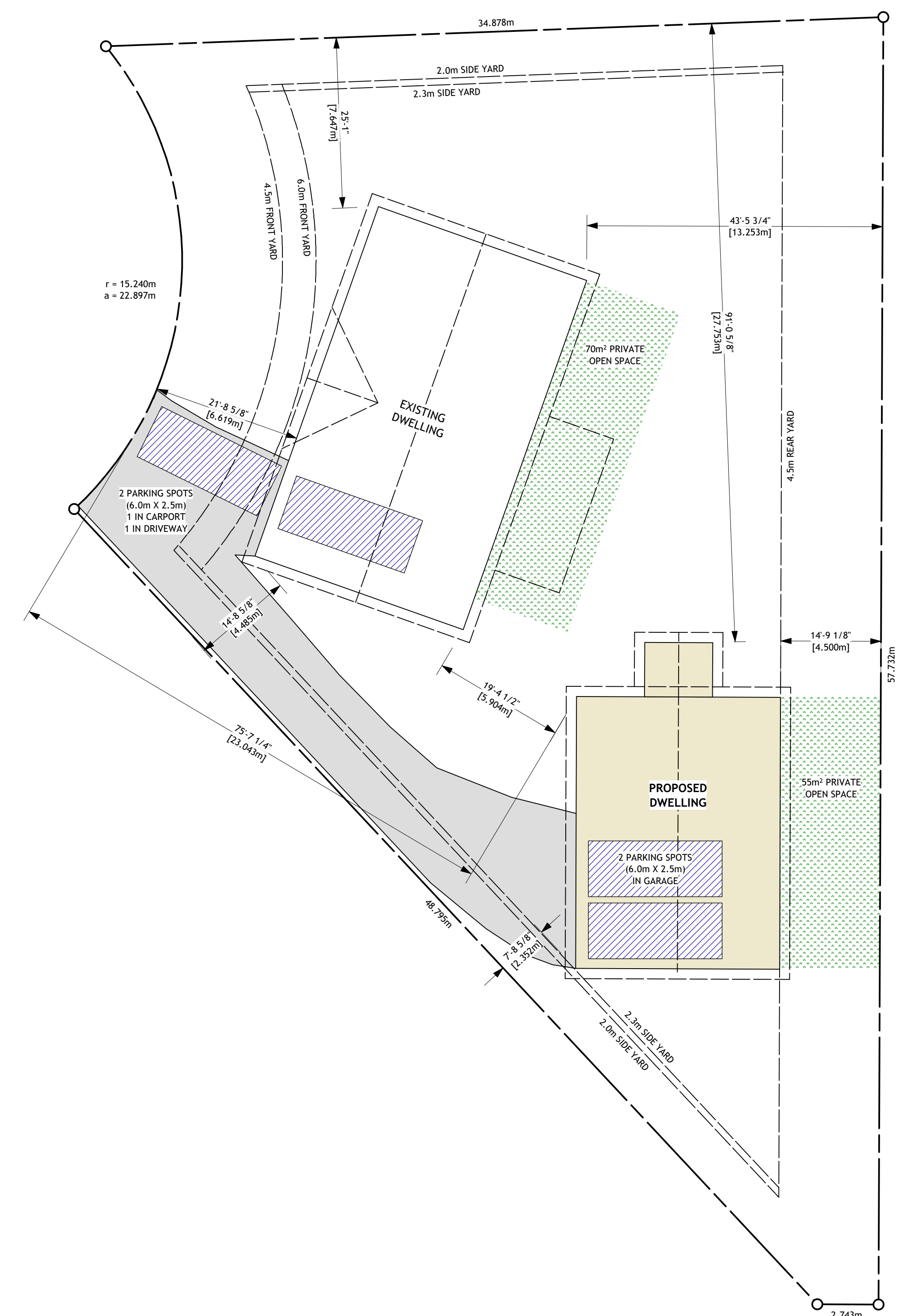

1 SITE PLAN
Scale: 1:150

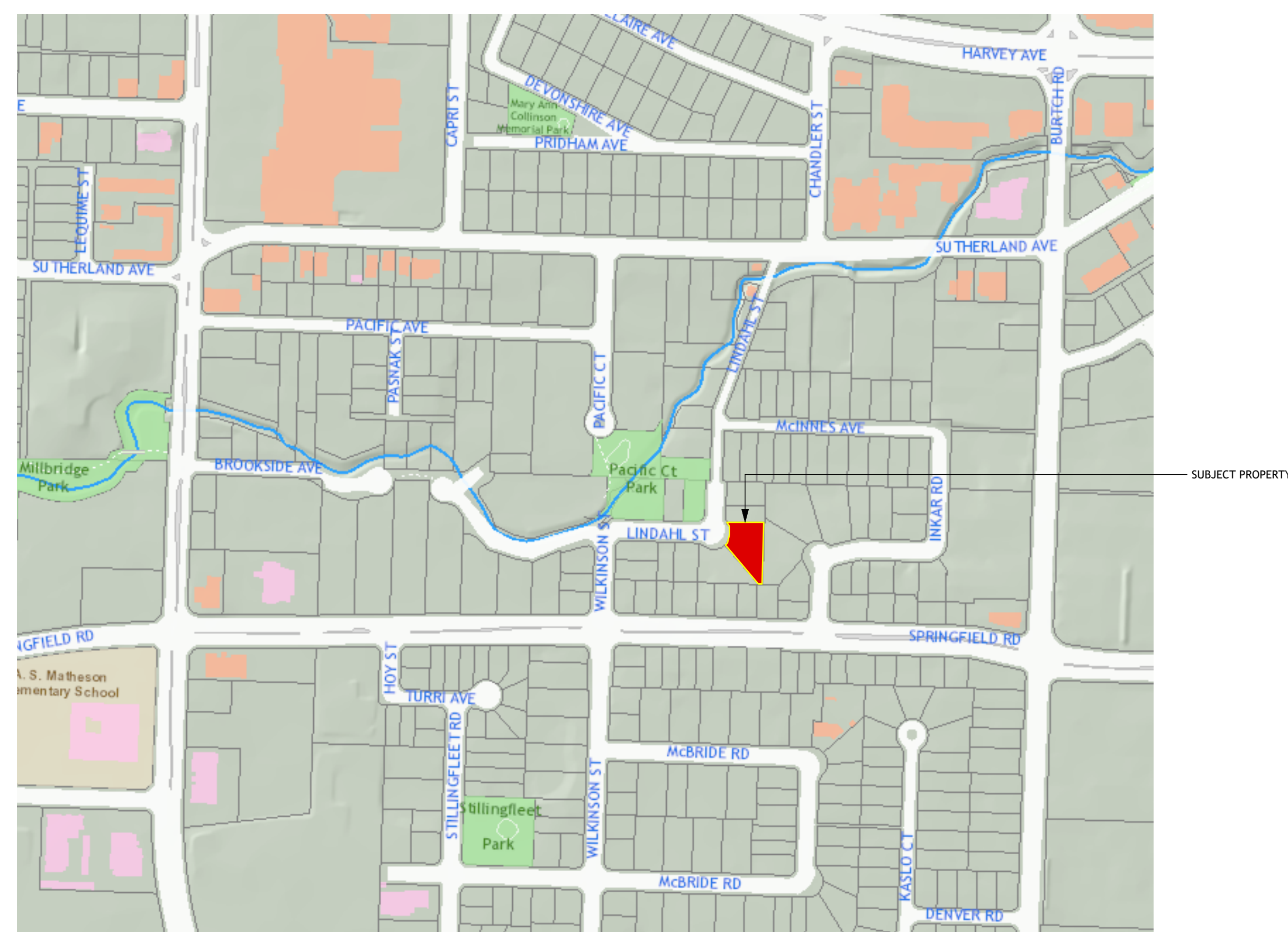

2 SITE CONTEXT